

**BMP CHALLENGE™ :**  
**Protecting corn farmers who adopt BMPs  
from yield and income risk, and  
documenting economic and environmental  
outcomes**

Thomas Green, Ph.D., C.C.A., T.S.P. \* IPM Institute of North America Inc.

*Harnessing the Power of the Marketplace to Improve Health, Environment and Economics*

2004, 2005 EPA Pesticide Environmental Stewardship National Champion

2005 EPA Children's Health Recognition Award Winner

2003 EPA Region V Recognition Award Winner

[www.bmpchallenge.org](http://www.bmpchallenge.org)



The IPM Institute  
of North America, Inc.

# Harnessing marketplace power...

**eco**  
**apples**

BORN AND RAISED HERE™

**WHOLE  
FOODS  
MARKET**



The world's largest retailer of natural and organic foods

Copyright © 2008-2011, Whole Foods Market, Inc.  
This site looks best when viewed with Internet Explorer



**ipm**  
Integrated Pest Management

5th National  
IPM Symposium  
*Delivering on a Promise*  
April 4-6, 2006, St. Louis

**SYSCO**



[www.bmpchallenge.org](http://www.bmpchallenge.org)

# Consumers Care!



# Goals

- *The INPUT PARADOX*
- *BMP CHALLENGE Net Returns Guarantee – Nutrient Management Example*
- *BMP CHALLENGE – Other Applications*
- *BMP CHALLENGE and Trading*



# Input paradox?

EPA, National Academy of Sciences and more than 20 other studies identify **ECONOMIC RISK** as a major culprit.

*“We’ve used a crop consultant in the past...*

*...if he’s wrong, the cost of him being wrong is much more than the cost of that additional insecticide or herbicide.”*



# “EXTRA” is a RATIONAL DEFENSE

## Against economic uncertainty

- *Nutrient mgt is an uncertain science - 1.2# N/bu no longer*
- *Nutrients may be lost if heavy spring rains occur*
- *Bumper crop conditions may call for more nutrients*
- *Minn. corn farmers apply an avg. of 43# extra N after legume; 69# after legume and manure*

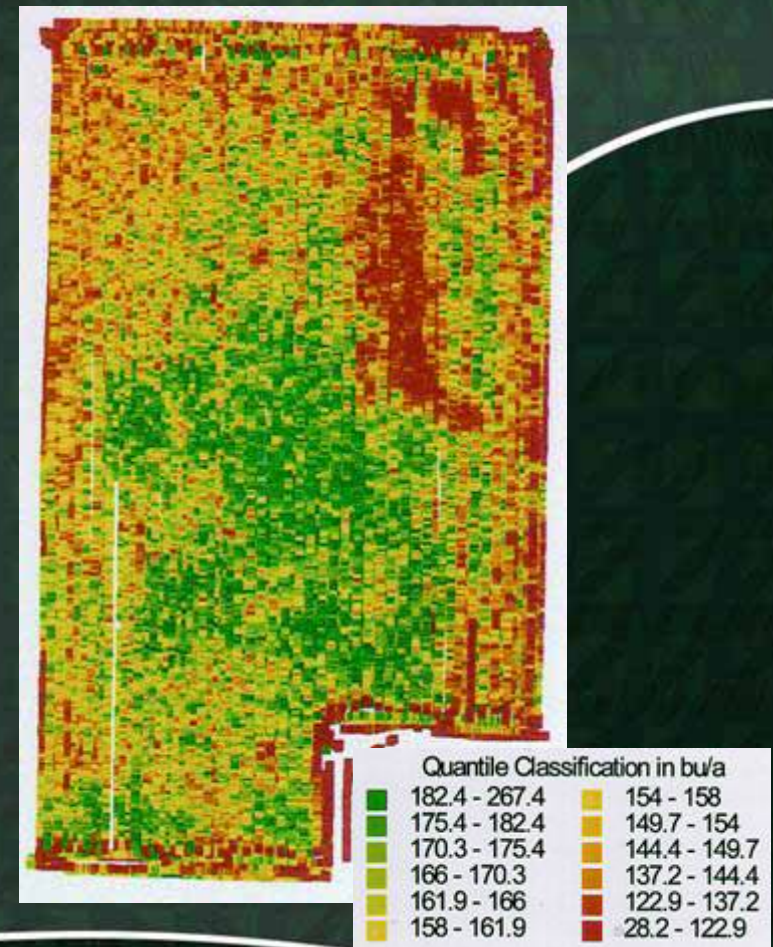

# 2005 corn farmer survey

- 700 farmers, each planting 850 acres of crops per year on average
- Some progress
  - 54% have reduced fertilizer over past five years, 18% by 15% or more
- Enormous potential for basic and advanced practice adoption
  - 16% do not credit N from soybeans
  - 25% do not credit nutrients in manure
  - 67% do not use variable rate
  - 88% do not use in-season testing/application

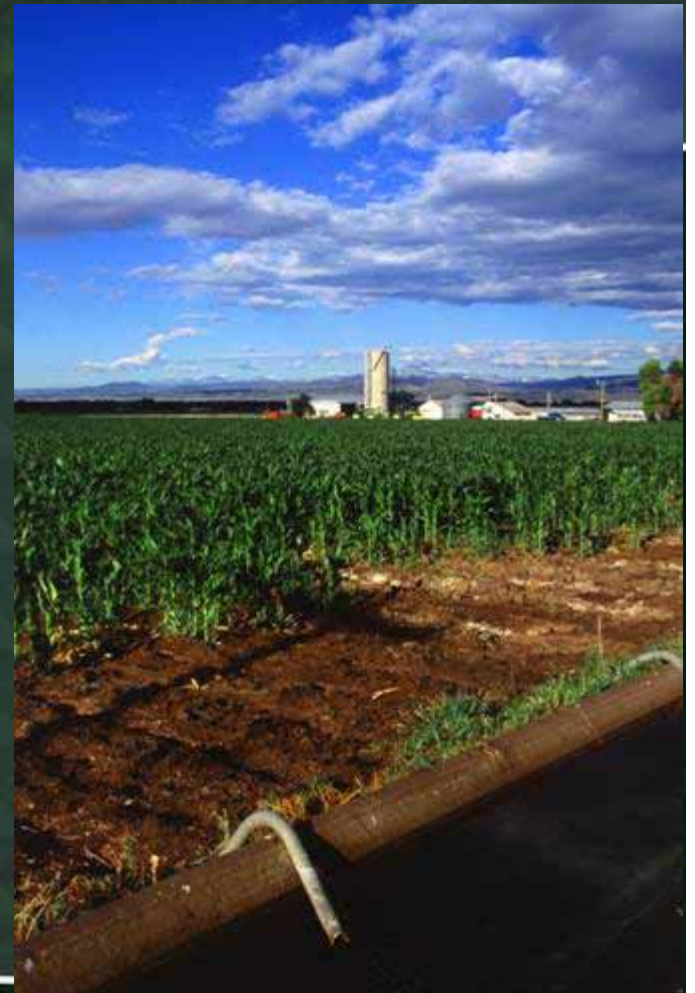

# 2005 corn farmer survey

- 46% want to see proof before changing practices
- 80% would be interested in reducing fertilizer rates if income were guaranteed

**ENTER THE...**

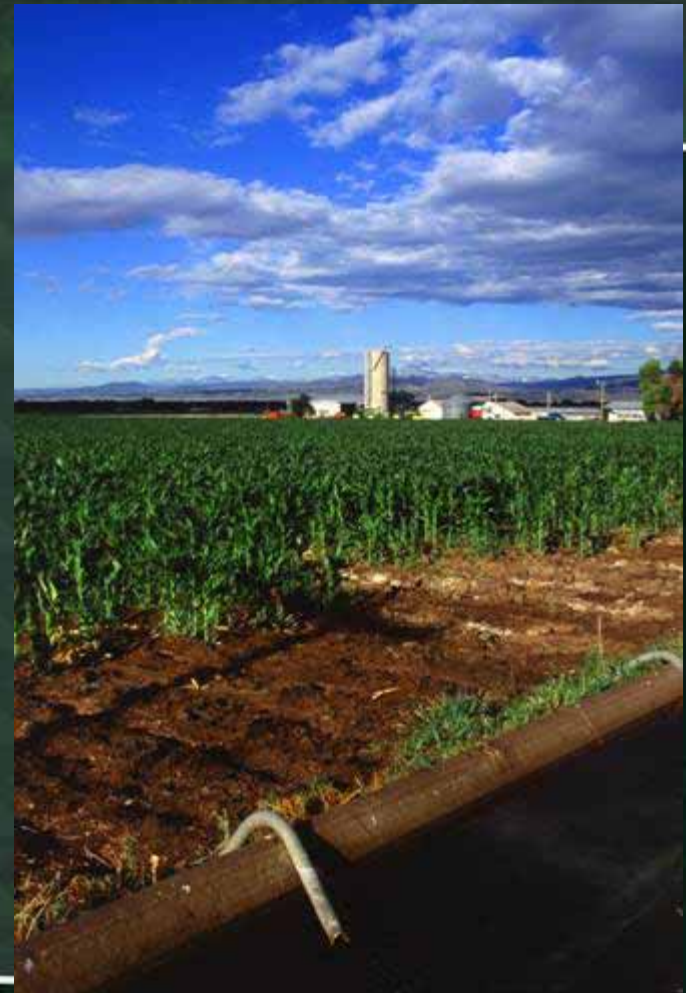

# BMP CHALLENGE: Mechanics, nutrients

- Farmer enrolls field(s)
- Crop advisor prepares N, P, K recommendation
- Farmer applies additional to check strip
- Farmer and crop advisor assess yield v. adjacent
- Farmer paid if yield loss (after fertilizer savings); **pays in if benefit ( $<1/3$ )**

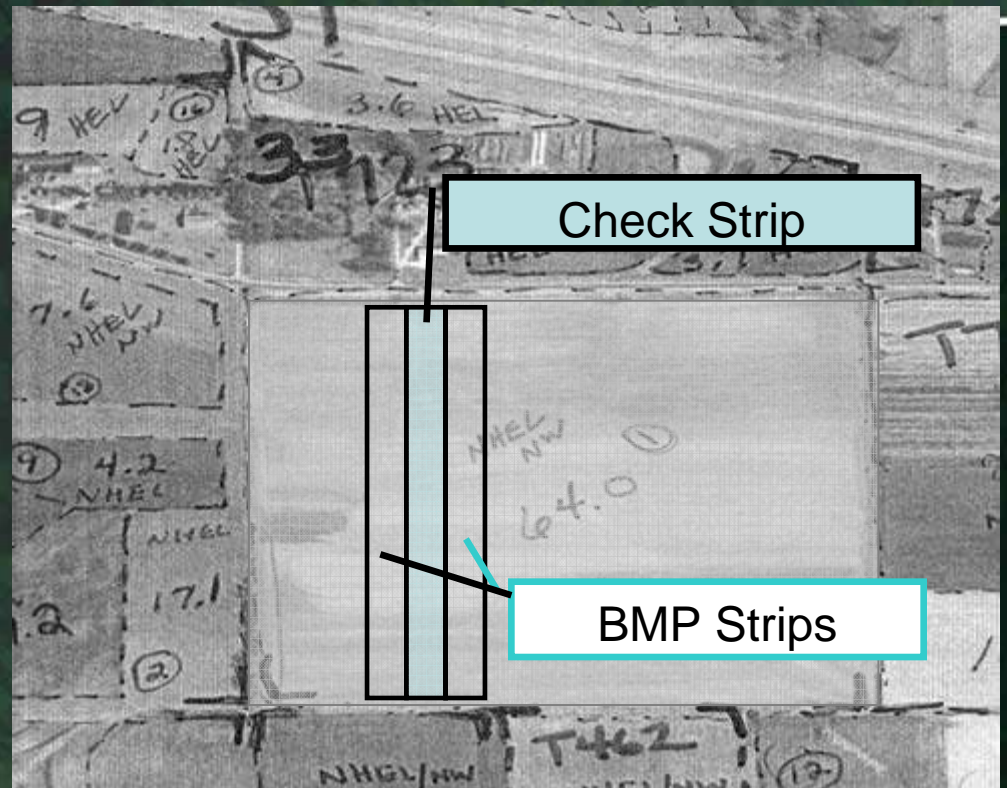

# Example from 2002: N only

	Conventional	BMP
Total Nutrients	208# N	168# N
Fertilizer Cost	\$40.56	\$32.76
Planning Cost	\$0	\$0
<b>Savings</b>	<b>\$7.80/acre, 40# N</b>	

Yield	87.1 bu/acre	87.9 bu/acre
Value (\$2.25/bu)	\$195.75	\$197.56
Yield Gain (loss)	\$1.81/acre, <1%	
<b>Guaranty payment</b>	<b>\$0</b>	

<b>FARMER NET</b>	<b>\$155.19/acre</b>	<b>\$164.80/acre</b>
<b>100 acre field</b>		<b>+\$967.00 (-\$322.30)</b>

# Example from 2003: N, P, K

	Conventional	BMP
Total Fertilizer	180-90-60	120-30-15
Fertilizer Cost	\$67.24	\$41.57
Planning Cost	\$0	\$0
<b>Savings</b>	<b>\$25.67/acre, 60# N, 60 #P, 45# K</b>	

Yield	206.1 bu/acre	187.9 bu/acre
Value (\$2.25/bu)	\$463.73	\$422.78
Yield Gain (loss)	(\$40.95/acre, 9% yield loss)	
<b>Guaranty Payment</b>	<b>\$15.28/acre</b>	

<b>FARMER NET</b>	<b>\$396.49</b>	<b>\$396.49</b>
-------------------	-----------------	-----------------

# Results 2002 to date

- **Avg. farmer benefit from BMP: (\$0.51)/acre**
  - 46 replicates, seven states
  - 2006 results pending, 25 fields, 3306 acres, six states
- **Cost for Nutrient BMP CHALLENGE: \$18/a**
  - Paid by third-party sponsor (e.g., EPA 319, Extension, state agency, ngo) plus farmer contribution
- **Average fertilizer savings**
  - 24% or 40# N/acre
- **2004: Corn Rootworm BMP CHALLENGE**
- **2005: First <BMP rate fields**
  - 2006 results pending, 18 fields in PA
- **2006: First REDUCED TILLAGE BMP CHALLENGE fields**
  - results pending, six fields, 850 acres, three states

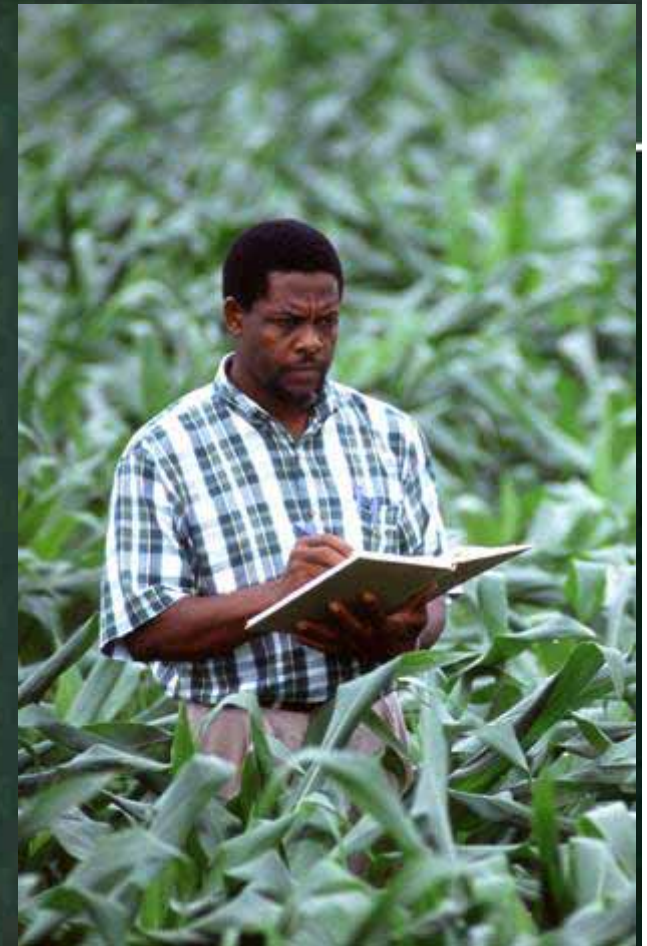

# 2006 BMP CHALLENGE

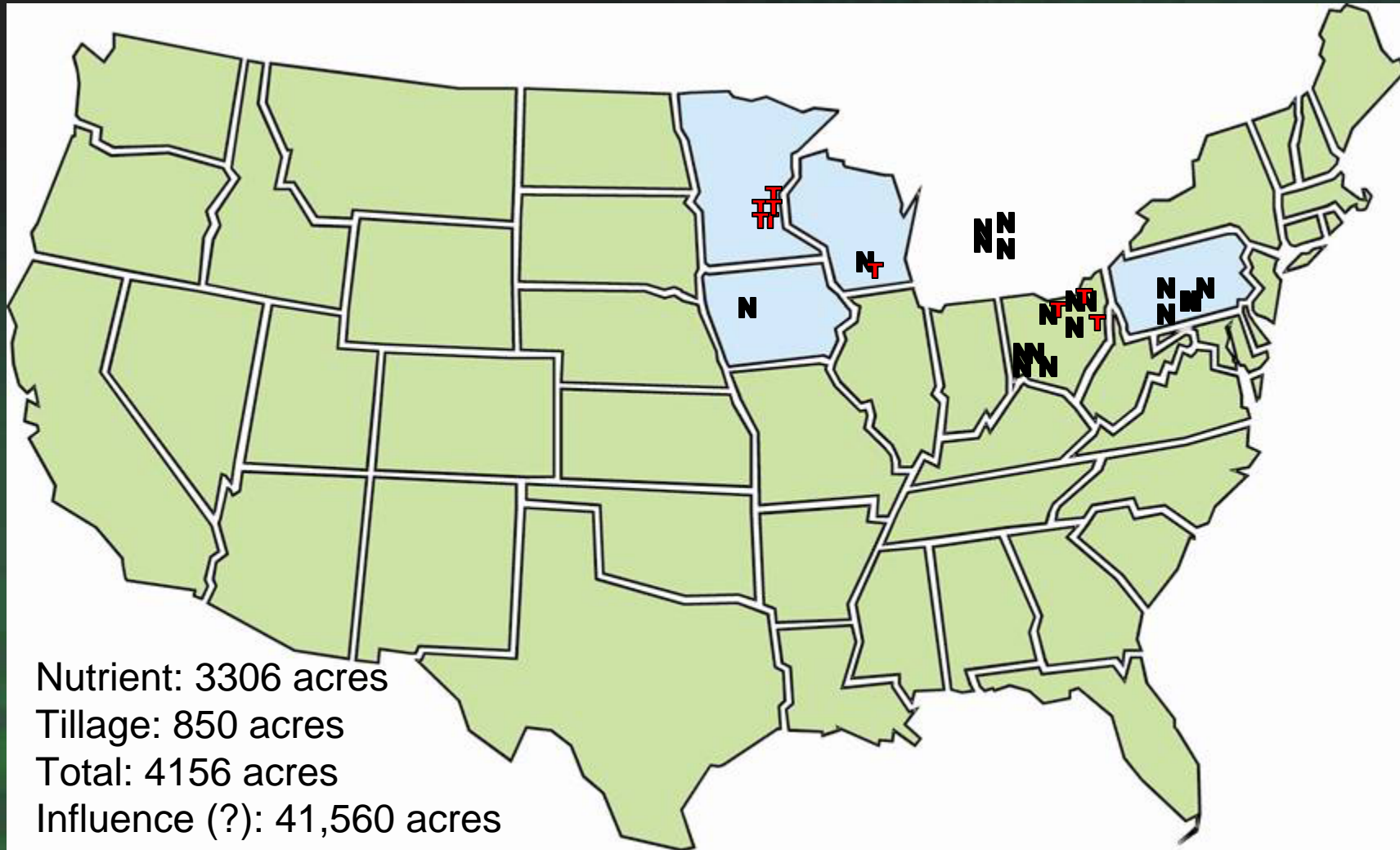

Nutrient: 3306 acres  
Tillage: 850 acres  
Total: 4156 acres  
Influence (?): 41,560 acres

# Trading Project, 2006-2009

- *Farmer income assured, plus any income from trade*
- *Credits verified by third party*
- *Farmers anonymous*
- *Credits defray guarantee cost*
- *Guaranty program aggregates credits*
- *Nutrient mgt, tillage, buffers, etc.*
- *NRCS Conservation Innovation Grant*



# BMP CHALLENGE Partners

- *American Farmland Trust's Agricultural Conservation Innovation Center*
- *IPM Institute of North America, IPM Works LLC, Agren Inc.*
- *Agflex: Iowa corporation, "bank" for reserves to make payments to farmers*
- *Kieser and Associates*
- *Thanks to The Nature Conservancy*

# BIG THANKS to:

Thomas Green, PhD, CCA, TSP  
IPM Institute of North America  
Madison WI, 608 232-1528  
ipmworks@ipminstitute.org

## Funders, Partners, Collaborators

American Farmland Trust ♦ Altria Group ♦ City of Decatur (IL)

Great Lakes Protection Fund

Illinois Council on Best Management Practices

Illinois Department of Agriculture

Iowa Farm Bureau Financial Services

Iowa Department of Economic Development

IPM Institute of North America ♦ Joyce Foundation

LeSueur County (MN) ♦ McKnight Foundation

Minnesota Department of Agriculture

National Fish and Wildlife Foundation

National Foundation for IPM Education ♦ Ohio State Extension

PA Dept of Agriculture ♦ Seven Mile Creek Watershed Project

US EPA ♦ University of Wisconsin ♦ USDA CSREES

USDA Small Business Innovative Research Program

USDA Natural Resources Conservation Service

USDA Risk Management Agency

Wisconsin Department of Natural Resources

Partners  
Wanted!

Photos courtesy USDA ARS Image Library  
[www.ars.usda.gov/is/graphics/photos/](http://www.ars.usda.gov/is/graphics/photos/)

[www.bmpchallenge.org](http://www.bmpchallenge.org)