



Final Conference Program



Conservation Science and Policy:
Global Perspectives and Applications
66th International Annual Conference
Washington DC • July 17-20, 2011 • www.swcs.org/11AC



66th SWCS International Annual Conference

Table of Contents

| | |
|---|-------|
| Conference Schedule in Brief..... | 2 |
| Welcomes & Volunteer Recognition | |
| Annual Conference Program Committee | 3 |
| National Capital Chapter | 4 |
| Conference Volunteers | 5 |
| Conference Registration & Facility Information | 6 |
| Omni Shoreham Map | 7 |
| Exhibitors, Sponsors & Contributors | 8-9 |
| SWCS Corporate Members..... | 11 |
| Daily Event Descriptions: | |
| Saturday | 13 |
| Sunday | 14-16 |
| Monday | 17-18 |
| Tuesday | 19-20 |
| Wednesday | 22-23 |
| Conference Presentation Schedules..... | 24-29 |
| Concurrent Session Descriptions: | |
| List of Symposia Sessions | 30-31 |
| Conservation Innovation Grants (CIG) Showcase Agenda..... | 33-34 |
| CIG Posters | 35 |
| Symposia Session Descriptions | 36-58 |
| Poster Presentations | 59-62 |
| SWCS Conference Sites & Presidents | 64 |

Conference Schedule In Brief

* Ticket Required

Saturday, July 16

| | | |
|------------|--|--------------------|
| 8:00 a.m. | SWCS Board of Directors Meeting | Cabinet Room |
| 10:30 a.m. | Conservation Leadership Workshop * | Council Room |
| 5:00 p.m. | Leadership Development Committee..... | Marquee Bar/Lounge |

Sunday, July 17

| | | |
|-----------|--|-----------------------------------|
| 8:30 a.m. | SWCS Committee Meeting (Science & Policy) | Senate Room |
| Noon | House of Delegates/State of Society Address/Town Hall Meeting..... | Palladian Ballroom |
| 1:30 p.m. | Technical Workshops * | Congressional A& B, & Forum Rooms |
| 1:30 p.m. | SWCS Committee Meeting (Editorial Board) | Senate Room |
| 1:30 p.m. | Student Member Forum | Council Room |
| 4:00 p.m. | Fellows Forum | Palladian Ballroom |
| 6:00 p.m. | New Members/First Timers Orientation..... | Congressional B Room |
| 6:30 p.m. | Welcome Reception in Exhibit Hall | Ambassador Ballroom |
| 7:30 p.m. | SWCS Committee Meeting (International) | Senate Room |
| 8:30 p.m. | SWCS Committee Meeting (Professional Development) | Council Room |

Monday, July 18

| | | |
|------------|---|---------------------|
| 8:30 a.m. | Opening Plenary: Pritchard Lecture | Regency Ballroom |
| 10:00 a.m. | Morning Break, Exhibits and Posters Open | Ambassador Ballroom |
| 10:30 a.m. | Concurrent Sessions | See Schedule |
| Noon | Lunch Break – Regional Roundtables * or On Your Own | Hampton Ballroom |
| 1:30 p.m. | Concurrent Sessions | See Schedule |
| 3:00 p.m. | Afternoon Break, Exhibits and Posters Open | Ambassador Ballroom |
| 3:30 p.m. | Concurrent Sessions | See Schedule |
| 7:30 p.m. | Networking Dessert Reception & Monument Tour * | Ambassador Ballroom |

Tuesday, July 19

| | | |
|------------|---|---------------------|
| 8:30 a.m. | Tuesday Special Plenary | Regency Ballroom |
| 10:00 a.m. | Morning Break, Exhibits and Posters Open | Ambassador Ballroom |
| 10:30 a.m. | Concurrent Sessions | See Schedule |
| 11:00 a.m. | ARSCSE Lunch & Annual Business Meeting * | Director’s Room |
| Noon | Lunch Break – Awards Luncheon * or On Your Own | Empire Ballroom |
| 1:30 p.m. | Concurrent Sessions | See Schedule |
| 3:00 p.m. | Afternoon Break, Exhibits and Posters Close at 3:30 | Ambassador Ballroom |
| 3:30 p.m. | Concurrent Sessions | See Schedule |

Wednesday, July 20

| | | |
|-----------|--|--------------------|
| 7:30 a.m. | Educational Tours #1, #2, & #4 * | Main Hotel Lobby |
| 8:30 a.m. | Educational Tours #3 & #5 * | Main Hotel Lobby |
| 8:30 a.m. | Farm Bill Forum * | Palladian Ballroom |
| Noon | Farm Bill: Paying for Performance Workshop * | Palladian Ballroom |

Continues on Thursday, July 21

Program Committee Welcome



*Rebecca Power, University of Wisconsin-Extension
Annual Conference Program Committee Chair*

Washington DC is hallowed ground for people everywhere inspired by the promise of democracy. Walking the streets of the city is like walking through a 3-D text book, with inspiring architecture and famous words at every turn. Successful agricultural enterprise was critical to the birth of the United States. Farmers (including U.S. “Founding Farmer” Thomas Jefferson) recognized that intact soils for crop or livestock production, and clean, abundant water supplies were necessary for life, liberty and the pursuit of happiness.

Regardless of country or culture of origin, people are united by two persistent challenges. First, we must provide sufficient food, water, shelter, fiber, and fuel for all people, while maintaining the means of production for future generations. Second, we must meet these fundamental human needs while economic, social, and environmental conditions undergo continuous change.

Clearly we have our work cut out for us. Farmers, agricultural organizations, local governments, state and federal agencies, private sector agricultural consultants, universities, environmental and conservation NGOs, food retailers all have insights and experiences necessary for solving complex problems. The 2011 Soil and Water Conservation Society Annual International Conference provides a forum for finding common ground and learning from our differences. This year, on behalf of the SWCS Annual Conference Program Committee, I invite you to talk with someone that approaches conservation from a different perspective than you. Ask them how we can bridge gaps between conservation science and policy. Make it a point to talk with someone from another country about how they are managing agricultural landscapes to meet our needs today and into the future. Continuous learning is the best way to adapt to continuous change.

I would like to thank this year’s Program Committee, the National Capital Chapter of the Soil and Water Conservation Society, and SWCS staff for the commitment and skill they’ve brought to this year’s annual conference. Through their leadership, we are offering a program that brings you local perspectives from across the country; national perspectives from leaders like this year’s Pritchard Lecturer Dan Glickman and our Farm Bill Forum on Wednesday morning; and international perspectives in Sunday’s Fellow’s Forum and our Tuesday plenary session moderated by past SWCS Board Chair Theo Dillaha. The National Capital Chapter has also arranged an excellent slate of tours that will bring history and conservation in the Washington D.C. area alive.

We recognize that many of you have shown extraordinary commitment to professional development by attending this year’s conference, despite the financial challenges faced by so many. You have my commitment that this event will bring you new resources and perspectives for your work at home.

2011 Annual Conference Program Committee

- *Chair – Rebecca Power*
- *Vice-Chair – Jeff Strock*
- *Secretary – Claire Baffaut*

Technical Team Leaders:

*Claire Baffaut, Tommy Bass, Tom Franklin,
Margaret Krome, Chris Obropta, Deanna Osmond,
Michelle Perez, Dan Towery, Don Tyler, Mary Watzin*

Liaisons:

- *Gregorio Cruz, CIG*
- *Rebekah DeWind, National Capital Chapter*
- *Jorge Delgado, SSSA S06*
- *Jorge Delgado, JSWC Editorial Board*
- *Theo Dillaha, International Committee*
- *Becky Fletcher, Leadership Development Committee*
- *Andy Manale, Science and Policy*
- *Jerry Neppel, Professional Development Committee*
- *Dan Towery, Board of Directors*
- *Dewayne Johnson, SWCS Staff*

National Capital Chapter Welcome



Rebekah DeWind, Natural Resources Conservation Service

On behalf of the National Capitol Chapter of the Soil and Water Conservation Society, welcome to the Nation's Capitol, the Omni Shoreham Hotel, and the 66th Annual SWCS Conference. The 2011 Local Planning Committee is pleased to be your hosts as we explore "Conservation Science and Policy: Global Perspectives and Applications".

We encourage you to take some extra time and explore the Nation's Capitol. As we all know when compromise plays a large part in today's Conservation Policy Process and Washington has been founded on this principle. Alexander Hamilton and Thomas Jefferson came to agree on the location of the "Federal City" in the Compromise of 1790, on the condition that the federal government assume the war debt carried by the States. For what was originally sited for just 100

square miles, Washington plays a preeminent role in Conservation Policy in the US and around the world. While it is joked that Washington was built in a swamp, the area originally consisted of farmland and forest. While one of the highest density cities in the US, Washington ties New York City for the largest percentage of parkland.

For the political junkies, Washington is full of adventure. Take a tour of the Capital and enjoy the new visitor's center. Why not stop in and talk to your local congressman or woman about conservation. For those with a less political bent, the Capitol offers a number of exciting opportunities.

For anyone who has not taken advantage of the many Smithsonian museums. For the naturalists, a stop at the Natural History Museum is a must. Two of my personal favorites are the Mammals Gallery and Butterflies and Plants, Partners in Evolution. For those who don't want to be doomed to repeat, the American History Museum can set them right. And my personal favorite, the National Zoo: Lions, and Tigers, and Panda Bears. Oh My!

As part of the US Department of Agriculture, the National Arboretum is a great place to brush up on your botany and take a look at some of the newest research going on in USDA.

With the focus on Conservation Policy no place could be more appropriate than Washington DC. As resource professionals we face a myriad array of new conservation challenges worldwide. It is vital that we incorporate the latest science into Conservation Policy. In a time of difficult financial times it is more important than ever that the Soil & Water Conservation Society membership takes an active part through conferences like this one to bring together conservation researchers, practitioners, and policy makers throughout the US and the world to share knowledge and experience which will shape conservations for years to come.

If you have any questions or need assistance, please ask any of the National Capitol Chapter representatives and they will be happy to assist.

National Capital Chapter Lead Volunteers

- Rebekah DeWind, NRCS, *Chair*
- Rebecca Roose, EPA, *Volunteer Coordinator*
- Dan Dostie, NRCS, *AV/Equipment*
- Ross Braun, *Silent Auction*
- Marc Safely, *Silent Auction*
- Doug Holy, NRCS, *Tours*
- Phil Spinelli, NRCS, *Tours*
- Lillian Woods, NRCS, *Fellows Forum*

Conference Volunteers

Concurrent Session Moderators, Tour Leaders, & AV Tech Support

Tom Basden
Peter Black
Jay Blair
Karen Blair
Ross Braun
Michael Brennan
Troy Daniell
Jimmy Daukas
Rebekah DeWind
Dan Doste
Carl Dupoldt
Tom Fedewa
Katie Flahive
Mitch Flanagan
Michael Formica
Dennis Fuchs
Jean Gagliardo
David Gagner
Fred Garst
Jon Gerken
Chris Gross
Cathleen Hapeman

Matthew Hostrander
Dennis Jones
Leonard Jordan
Bruce Knight
Carol Kramer-LeBlanc
Dana Larsen
Aaron Lauster
Evelyn Lurtz
Andy Manale
Pat McIlvaine
Becky Mitschele
Michelle Perez
Mike Permenter
Shannon Phillips
Janice Reid

Rebecca Roose
Marc Safley
Kendrick Safley
Neil Sampson
Jim Scott
Jerry Seinwill
Chris Smith
Phil Spinelli
Harold Thompson
Dan Towery
Norman Widman
Bruce Wight
Gene Yagow
Dana York

Thank you so much to all of these volunteers for all their contributions and work in putting on a great event.

SWCS Board and Staff

SWCS Board of Directors

Region 1 Northeastern: Bill Boyer
Region 2 Southeastern: Mark Berkland
Region 3 South Central: Danny Hughes
Region 4 East North Central: Gary Steinhardt
*Region 5 West North Central: Peggie James**
Incoming Director: Pete Nowak
Region 6 Northern Plains: Anita Nein
Region 7 Southwestern: Jerry Pearce
*Region 8 Western: Don Wysocki**
Incoming Director: Mark Steffek
Region 9 Canada: Tom Prout
*At Large Directors: Clark Gantzer, Dan Towery, Melinda McClanahan**
Incoming Director: Steve Young
*Student Director: Rich Kann**
Incoming Director: Andrew Paxson
**Terms expire at end of conference*



SWCS Staff

- James Bruce, Canadian Policy Representative
- Oksana Gieseman, Publications Director/Editor
- Jim Gulliford, Executive Director
- Dewayne Johnson, Professional Development Director
- Linda Larson, Receptionist/Mail Clerk
- Sue Ann Lynes, Executive Assistant/Corp. Membership
- Lisa Manley, Member Services Specialist
- Jody Ogg, Comptroller
- Jacqueline Pohl, Editorial Assistant

Conference Registration & Facility Information

The Soil and Water Conservation Society registration desk is located on the second floor at the top of the escalator. SWCS staff members will be on-site to assist you.

Registration Hours:

| | |
|----------|------------------------|
| Saturday | 9:30 a.m. — 11:30 p.m. |
| Sunday | 10:30 a.m. — 7:30 p.m. |
| Monday | 8:00 a.m. — 5:30 p.m. |
| Tuesday | 8:00 a.m. — 5:30 p.m. |

Tickets and Passes

The conference registration fee covers one participant. Formal name badges are not provided for guests. Additional tickets for guests to attend the Welcome Reception on Sunday evening in the Exhibit Hall, Networking Dessert Reception and Monuments at Night Tour, educational tours, roundtable lunch, or the Awards lunch may be purchased at the Registration Desk and are subject to availability. Admission to sessions (including the plenary sessions), exhibits, posters, and special events is by formal name badge or ticket. Your name badge should be worn at all times during the conference. For your safety, do not wear your name badge outside the conference area.

Registration packets will contain formal name badges and tickets for purchased events for all registered attendees. Tickets will be collected for all ticketed events. If available, event tickets may be purchased at the registration desk during registration hours.

Please Note: No refunds will be given for conference registrations, workshops, tours, meal functions, or activities. Registration personnel will not exchange tickets. SWCS reserves the right to cancel events/activities without prior notice.

Lost and Found

Check with the Omni registration desk or at the SWCS registration desk.

Medical Services

For medical emergencies, dial "0" from any house phone or room phone.

Messages

A message board is located near registration. To preserve the educational quality of the conference, meetings will not be interrupted for personal announcements or messages.

CEUs

SWCS has worked to secure continuing education credits from various certifying organizations. Certified, licensed, or professional engineers (PE), agronomists (CPAg), soil scientists and classifiers (CPSS and CPSC), crop advisors (CCA), crop consultants (CPCC), foresters, range managers (CPRM), grassland professionals (CGP), professionals in erosion and sediment control (CPESC) and storm water quality (CPSWQ), and other professional conservationists may be able to obtain continuing education credits.

Pick up a CEU tracking/sign in sheet at the registration desk and have each room moderator sign the sheet as appropriate. **Return the form to registration at the end of the conference.**

If the certification you are seeking is not listed above, please ask at the conference registration desk for a self-certify form for CEUs.



Soil and Water Conservation Society – 66th International Annual Conference

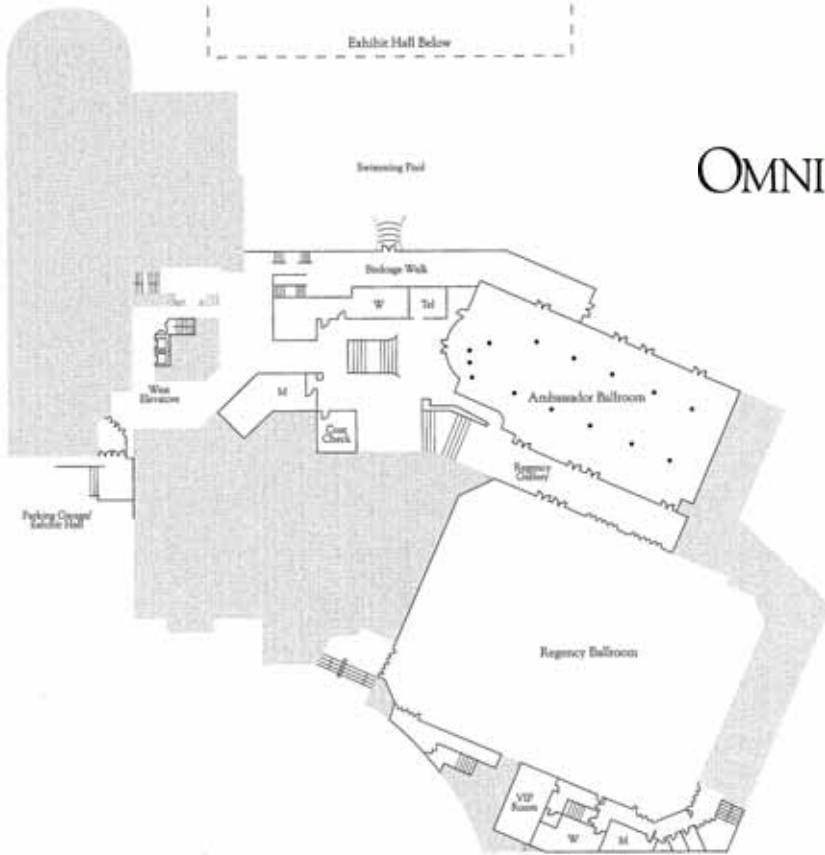
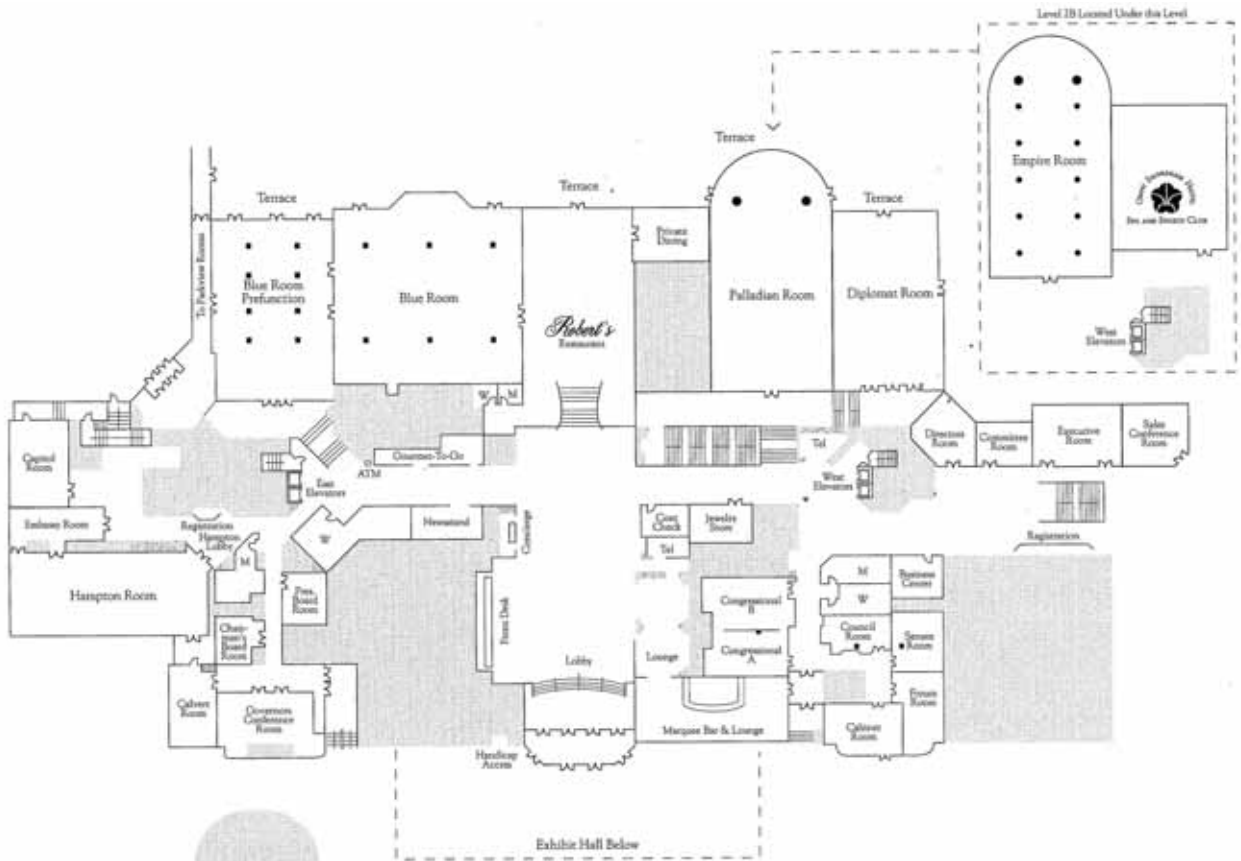

OMNI  HOTELS

Exhibitors, Sponsors & Contributors

The Soil and Water Conservation Society gratefully acknowledges the participation and support of the following exhibitors for the 2011 Annual Conference.

Exhibitors

| Booth | Exhibitor | Booth | Exhibitor |
|-------|--------------------------------|-------|---|
| 1 | Agren | 14 | USDA NRCS |
| 2 | Agri Drain Corporation | 15 | Wiley-Blackwell |
| 3 | Forrest Keeling Nursery | 17 | National Ag Library - Water Quality Info Center |
| 4 | EnviroCert International, Inc. | 18 | USDA National Ag Statistic Service |
| 5 | The Nature Conservancy | 19 | Earth Team |
| 12 | DriWater, Inc. | 20 | USDA/NRCS |
| 13 | USDA Economic Research Service | 21 | Oregon Ryegrass Growers Seed Commission |

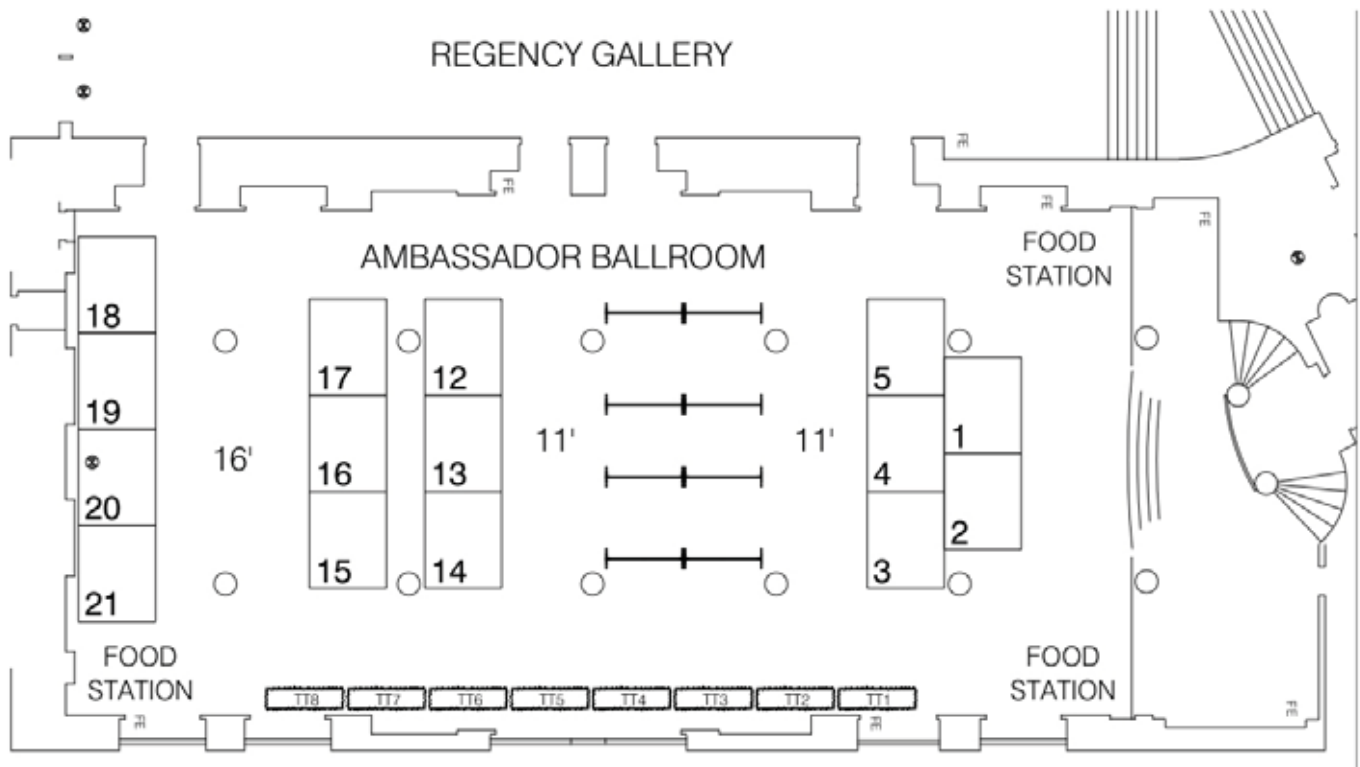



Conservation Science and Policy:
Global Perspectives and Applications
66th International Annual Conference
Washington DC • July 17-20, 2011 • www.swcs.org/11AC

The Soil and Water Conservation Society is pleased to recognize our 2011 Conference Sponsors



Coffee Break Sponsors



National Capital Chapter

Additional Conference Partnerships

USDA-NRCS - Conservation Innovation Grant Program

National Institute of Food and Agriculture (NIFA)

Farm Foundation, Winrock International, American Farmland Trust

Association of Retired Conservation Service Employees

Convert a few minutes into huge rewards!

THAT'S THE PROMISE OF AGREN'S CONSERVATION PLANNING TOOLS.

Why spend 40+ hours planning a conservation practice like a pond, waterway, or wetland, when you can create multiple options for a single site in just 30 minutes with smart online software?



What will Agren tools do for your team?

- Cut your project time from days to typically less than an hour
- Allow you to produce more options to share with landowners
- Provide accurate cost estimates
- Simplify the use of LiDAR elevation data

**WHO CAN ARGUE WITH FAST, EASY AND ACCURATE?
COME SEE FOR YOURSELF & GET A SHOT AT THE IPAD!**

AGREN

www.agrentools.com

SWCS Corporate Members

SWCS is pleased to have the following organizations as corporate members and partners in the effort to advance natural resource conservation and environmental sustainability. For more information about how you can add your organization's name to this list, please call 1-800-THE-SOIL or email sueann.lynes@swcs.org.

GOLD

Agren Inc.

Agri Drain Corporation



SILVER

The Nature Conservancy



BRONZE

Ag Business Consultants

Agricultural Engineering Services PLLC

Aspinwall

Conservation Technology Information Center

EnSave Inc.

Forrest Keeling Nursery

Logiag Inc.

Pioneer Hi-Bred, A DuPont Business

Propane Education and Research Council

Stock Seed Farms

Validus Services LLC

White River Irrigation District



The **WATER** INTRODUCING **GATE**™

Conserve Water • Increase Yields • Reduce Nutrient Loss

The Water Gate maintains a one foot increase in water elevation between the downstream side of the valve and the upstream side of the valve.

The Water Gate operates in either OPEN (Drainage Mode) or CLOSED (Head Pressure Mode). The Closed (Head Pressure Mode) is activated by backing water up into the valve. This is accomplished by installing a Water Level Control Structure, (WLCS) in the tile main at the lowest point of the drainage system that you wish to manipulate or control. Locate the first Water Gate one foot in elevation upstream from WLCS. Water Gates can be used in series, locating additional units at one foot elevation intervals.

- *Manage up to 8" Diameter Subsurface Drains*
- *Fully Automatic*
- *Float Operated*
- *Infinitely Variable*
- *Completely buried to allow for convenient field operations*



Side view of how Inline Water Level Control Structure and Water Gates "Stair-Step" water up through the soil profile.



Patent Pending

NEW!



Agri Drain
CORPORATION

1462 340th Street • Adair, IA 50002
800-232-4742 • www.agridrain.com

Saturday, July 16 Events



| | | |
|------------|------------------------------------|--------------------|
| 8:00 a.m. | SWCS Board of Directors Meeting | Cabinet Room |
| 10:30 a.m. | Conservation Leadership Workshop * | Council Room |
| 5:00 p.m. | Leadership Development Committee | Marquee Bar/Lounge |

Saturday Event Descriptions

Conservation Leadership Development Workshop

10:30 a.m. – 5:00 p.m.

Council Room for Education Sessions, Lunch with the SWCS Board in Forum Room

Agenda

| | | |
|------------|---|---|
| 10:30 a.m. | Welcome, Introductions, Housekeeping | Becky Fletcher, Chair, SWCS Leadership Development Committee |
| 10:45 a.m. | Chapter Stories | Cathy McGuire, Arizona Chapter |
| | Successful Collaborations, Partnerships, Programs, Projects, Fundraising | Ross Braun, Missouri/National Capital Chapters Larry Wright, Oklahoma Chapter |
| 11:45 a.m. | Professional Development Committee Updates | Jerry Neppel, Chair, SWCS PD Comm. |
| 12:00 p.m. | Lunch (with Board of Directors) | SWCS President Bill Boyer Executive Director Jim Gulliford |
| 1:30 p.m. | Building a Successful Grassroots Advocacy and Government Affairs Program | Steven Kline, Director, Center for Agricultural & Private Lands, Teddy Roosevelt Conservation Partnership |
| | Building a Strong Chapter Advocacy Program | Dennis Pate, Iowa Chapter |
| 2:45 p.m. | Break | |
| 3:00 p.m. | Your Role as a Non-profit Leader | Larry Wright, Oklahoma Chapter |
| | SWCS Q&A: Officer Roles, Legal and Fiduciary Responsibilities, Budgeting, Membership, Meetings, Long-Range Planning, Chapter and Non-Profit Resources | Jody Ogg, SWCS Comptroller Dewayne Johnson, SWCS Professional Development Director |
| 4:30 p.m. | Wrap Up, Evaluations, Future Directions Discussions | Becky Fletcher |

Sunday, July 17 Events

| | | |
|-----------|---|-----------------------------------|
| 8:30 a.m. | SWCS Committee Meeting (Science & Policy) | Senate Room |
| Noon | House of Delegates/State of Society Address/Town Hall Meeting | Palladian Ballroom |
| 1:30 p.m. | Technical Workshops * | Congressional A& B, & Forum Rooms |
| 1:30 p.m. | SWCS Committee Meeting (Editorial Board) | Senate Room |
| 1:30 p.m. | Student Member Forum | Council Room |
| 4:00 p.m. | Fellows Forum | Palladian Ballroom |
| 6:00 p.m. | New Members/First Timers Orientation | Congressional B Room |
| 6:30 p.m. | Welcome Reception in Exhibit Hall | Ambassador Ballroom |
| 7:30 p.m. | SWCS Committee Meeting (International) | Senate Room |
| 8:30 p.m. | SWCS Committee Meeting (Professional Development) | Council Room |

Sunday Event Descriptions

House of Delegates, State of Society Address, and Town Hall Meeting

Sunday, July 17 • Noon – 1:30 p.m.

Palladian Ballroom

The meeting will begin at noon and includes President Bill Boyer's State of the Society address, Jim Gulliford's Executive Director update, the House of Delegates session, and a Town Hall Meeting. This event is open to all.



Topic of Discussion for the Town Hall Meeting

The United States has committed to an energy policy that includes an aggressive expansion of biofuel production. There are many biofuel feedstock options under consideration; crop residue, perennial grasses, wood byproducts, algae and others. In September, 2010, the SWCS hosted a workshop to develop regional roadmaps for sustainable advanced biofuel feedstock production. In your region, are the initiatives to develop and utilize biofuel feedstock demonstrating appropriate concern for soil conservation, water quality, and soil quality implications?

Student Members Information Session

Sunday, July 17 • 1:30 p.m.

Council Room

Students are encouraged to attend this session on conservation careers. Each speaker will give a three to four minute overview of the programs, services, and/or products offered by their agency or company and briefly discuss their education and career background.

Roundtable Discussion: The floor will be open for students and student chapter advisors to ask questions of the speakers.

Technical Workshops

All of the technical workshops are held on Sunday, July 17 from 1:30 p.m. to 4:00 p.m.

COMET-VR Version 2.0, Evaluating Farm-Level Carbon Footprint and GHG Reduction Potential Workshop A - Congressional A

Organizer: USDA-NRCS and the Colorado State University Natural Resources Ecology Laboratory

Speakers: Carolyn Olson, USDA-NRCS and Keith Paustian, Colorado State University

Getting Back to Conservation Planning Workshop B - Congressional B

Organizer: Agren, Inc.

Speakers: Tom and Stan Buman, Agren, Inc.

Soil Health Cropping and Grazing Systems Workshop E - Forum Room

Organizer: Richard Webb

Speakers: Richard Webb, Michelle Jezeski



Conservation Science and Policy:
Global Perspectives and Applications
66th International Annual Conference
Washington DC • July 17-20, 2011 • www.swcs.org/11AC

Fellows Forum

Sunday, July 17 • 4:00 – 6:00 p.m.

Palladian Ballroom

This year's Fellows Forum will focus on *How globalization affects conservation science, policy, and practice.*

Countries have shared conservation knowledge with each other over the years in an effort to learn practices that would be applicable for use in their country. With the conference in the nation's capitol, this is an opportunity to highlight international activities. There has been a history of exchanges of natural resource information, personnel, and site visits on various mutually beneficial resource concerns. The forum will provide the opportunity to discuss international opportunities for resource management.

Examples include:

- A Chilean delegation visited the U.S. to discuss how a federal agency uses GPS and related technologies in agriculture applications.
- A 10-person delegation of Iraqi soils scientists came to the U.S. under the Cochran Program to learn more about U.S. soils science practices.
- An U. S. government multi-agency effort with Haiti developed the "Natural Resource Management Assessment of Threats to Agricultural Production" for five watersheds. The purpose of the watershed plans were to identify natural resource management threats to agricultural productivity in selected fertile plains, to identify interventions to mitigate those threats, and to increase agricultural productivity.
- International attention has turned to Afghanistan and Iraq as the countries transition from war to rebuilding infrastructure and managing natural resources. U. S. has sent staff to serve on long-term assignments varying from being advisors at the ministerial level to technical advisors for field-based Provincial Reconstruction Teams.

The Fellows Forum will explore these issues and feature the following speakers:

- The USDA role in International Conservation – Rene Hadjigeorgalis, Branch Chief, Rural Development and Natural Resources, Foreign Agricultural Service, Washington, DC
- Reports from a Agricultural Advisor in Afghanistan, Iraq, and recently Pakistan – Mike Gangwer, Foreign Agricultural Service, Washington, DC
- Efforts and impacts of developing a Global Soil Map – Jon Hemple, Director, National Soil Survey Center, Natural Resources Conservation Service, Lincoln, NE
- How international research cooperation in Africa, Asia and Latin America is benefiting U.S. efforts to address land use change and management – Jeffery Herrick, Research Soil Scientist, Agricultural Research Service, Las Cruces, NM
- Moderator: Melvin Westbrook, Director, International Conservation Division, Natural Resources Conservation Service

New Members/First Timers Meeting

Sunday, July 17 • 6:00 p.m. — 6:30 p.m.

Congressional B

If you are a new member or are attending the Soil and Water Conservation Society Annual Conference for the first time, be sure to attend this orientation. This is a great opportunity to learn about the conference and the Society, ask questions about events, and meet other new members. Tom Buman, Agren, and Lisa Manley, SWCS Member Services Specialist, conduct this annual event.

Welcome Reception

Sunday, July 17 • 6:30 p.m. – 8:00 p.m.

Exhibit Hall – Ambassador Ballroom

Poster Displays – Regency Ballroom

Join fellow attendees and ticketed guests in the Exhibit Hall to greet our conference exhibitors, bid on Silent Auction items, and speak with the authors of the posters submitted for the annual conference. Appetizers will be served. A cash bar is available.

Exhibit Hall / Poster Room Hours

Sunday:

Exhibitor/Poster Set up beginning at 1:30 p.m.

Welcome Reception from 6:30 p.m. – 8:00 p.m.

Monday:

Open from 10:00 a.m. – 3:30 p.m.

Posters in Regency need to be down by 5:00 p.m.

Tuesday:

Open from 10:00 a.m. – 3:30 p.m.

Exhibitor/Poster tear down beginning at 3:30 p.m.

All posters need to be removed by 5:00 p.m.

Silent Auction

Proceeds from the 2011 Silent Auction will be used by the National Capital Chapter to support continuing education and leadership development.

Drop Off:

Sunday, July 17 • Noon – 6:00 p.m.

Bidding:

Sunday, July 17 • 6:30 – 8:00 p.m.

Monday, July 18 • 10:00 a.m. – 3:30 p.m.

Tuesday, July 19 • 10:00 a.m. – 3:15 p.m.

Bidding Closes/Winners Announced:

Tuesday, July 19 • 3:10 p.m.

Payment by cash or check only.

Silent Auction items can be dropped off at the National Capital Chapter table in the Exhibit Hall beginning at Noon on Sunday. Auction items will be located throughout the Exhibit Hall in exhibit booths and on special tables. Bidding on auction items will begin when the Exhibit Hall opens at 6:30 p.m. on Sunday evening for the Welcome Reception.

Successful bidders:

Successful bidders need to pick up and pay for their items by 5:30 p.m. on Tuesday or they will be offered to the next highest bidder. Conference attendees will be bidding on a unique and diverse variety of items thanks to the generous donations by chapters from around the country.



Wondering how to fill your entry level positions?

The Soil and Water Conservation Society Career Center is an online resource to help employers and job seekers make career connections in the conservation community.

Early career professionals bring fresh ideas, new energy and can keep your company or agency current with modern trends and tactics.

Turn to the SWCS Career Center to reach this early career audience.

SWCS Career Center

Visit www.swcs.org/careers to post a job or your resume today.

You can't afford not to.



Monday, July 18 Events

| | | |
|------------|---|---------------------|
| 8:30 a.m. | Opening Plenary: Pritchard Lecture | Regency Ballroom |
| 10:00 a.m. | Morning Break, Exhibits and Posters Open | Ambassador Ballroom |
| 10:30 a.m. | Concurrent Sessions - Schedule on page 24 Regency, Diplomat, Executive, Palladian, Forum, Congressional A, Congressional B, Cabinet, Empire, Senate, & Council | |
| Noon | Lunch Break – Regional Roundtables * or On Your Own | Hampton Ballroom |
| 1:30 p.m. | Concurrent Sessions - Schedule on page 25 Regency, Diplomat, Executive, Palladian, Forum, Congressional A, Congressional B, Cabinet, Empire, Senate, & Council | |
| 3:00 p.m. | Afternoon Break, Exhibits and Posters Open | Ambassador Ballroom |
| 3:30 p.m. | Concurrent Sessions - Schedule on page 26 Regency, Diplomat, Executive, Palladian, Forum, Congressional A, Congressional B, Cabinet, Empire, Senate, & Council | |
| 7:30 p.m. | Networking Dessert Reception & Monument Tour * | Ambassador Ballroom |

Monday Event Descriptions

Opening Plenary Session:

H. Wayne Pritchard Lecture

Monday, July 18 • 8:30 a.m.

Regency Ballroom

Part I: Pritchard Lecture

Dan Glickman -- Food Security, Ecosystem Services, and Agricultural Policy: Farming for the Future

Mr. Glickman will share his thoughts and personal experiences on the long-term implications of food and agricultural policy on conservation in the United States and around the world.

Mr. Glickman is currently Director of Congressional Programs at the Aspen Institute. He is co-chair of AGree, a multi-Foundation effort to look at the long term prospects for food and agricultural issues. He is a Senior Fellow at the Bipartisan Policy Center in Washington, DC, and is also currently serving as the co-chair of the Chicago Council on Global Affairs' global agricultural development initiative.

He served as the U.S. Secretary of Agriculture from March 1995 until January 2001. Under his leadership, the Department administered farm and

conservation programs; modernized food safety regulations; forged international trade agreements to expand U.S. markets; and improved its commitment to fairness and equality in civil rights. He was a member of Congress from Kansas from 1977-1995. During that time, he served as a member of the House Agriculture Committee.

Part II: Conservation Practices to Mitigate and Adapt to Climate Change

Andy Manale, SWCS Science and Policy Committee
Jorge Delgado, SWCS Climate Change Taskforce

In response to a resolution adopted by the SWCS House of Delegates at the 2010 international annual meeting, the SWCS Board of Directors of the Soil and Water Conservation Society, tasked the Executive Director and the Science and Policy Committee (chaired by Andy Manale) to develop a position statement on agriculture, conservation and climate change. The Committee established a taskforce, chaired by Jorge Delgado, to review the science regarding the roles that soil and agriculture play to help mitigate greenhouse gas emissions and reduce the social, economic, and environmental impacts of climate change. This presentation by Jorge Delgado and Andy Manale, will summarize the work of the task force and the committee and present the policy statement.

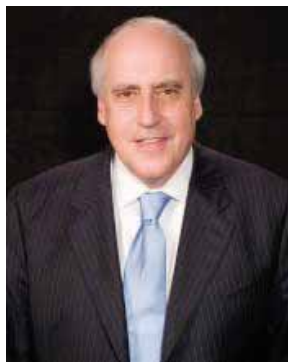

Monday Descriptions Cont'd

Concurrent Sessions

Symposia and Oral Presentations

Monday, July 18 • 10:30 a.m. to Noon

Monday, July 18 • 1:30 p.m. to 3:00 p.m.

Monday, July 18 • 3:30 p.m. to 6:00 p.m.

See Pages 24-26 for the Monday schedules.

Regional Roundtable Lunches

Monday, July 18 • Noon to 1:30 p.m.

The buffet line for this lunch will be located in the Hampton Ballroom, which is in the East Wing of the Omni Shoreham. Please go through the line in Hampton and then proceed to your regional lunch room.

| <u>Region(s)</u> | <u>Room</u> |
|--|--------------|
| East North Central & West North Central | Calvert |
| Northern Plains, Southwest & West | Presidential |
| Northeastern, Canadian, & International | Hampton |
| South Central & Southeastern..... | Capitol |

Tickets (\$56 each) to the Regional Roundtable Lunches will be available until 9:00 a.m. Monday morning.

Networking Dessert Reception and Monuments at Night Tour

Monday, July 18

7:30 p.m. - Dessert Reception in Ambassador

8:30 p.m. - Load Buses at Parkview Entrance

A limited number of tickets for the tour were still available at press time. If there are seats available on the bus, they are \$75 each. Check at registration.

Join us for a special dessert reception in the Exhibit Hall at the Omni Shoreham with members of the National Association of Conservation Districts and other partners. This unique opportunity to network with our conservation partners at NACD will be followed by an evening bus tour of lighted monuments.

WASHINGTON FAVORITES AT NIGHT

Washington is spectacular at night. We will enjoy a narrated riding tour as we travel along Constitution, Independence, and Pennsylvania Avenues viewing the nation's capital bathed in lights. View the Washington Monument, Capitol, and, when we disembark from the coach, you can enjoy the impressive panorama from the steps of the Lincoln Memorial. We will visit the inspiring FDR Memorial from which we will see the Jefferson Memorial. Our tour will proceed across Memorial Bridge to the Iwo Jima Memorial, and pass several other famous landmarks.

Session, Workshop, Tour & Speaker Evaluation Form Online

Evaluate speakers right now on your smartphone or later from your computer. Go to www.swcs.org/11eval or use the QR code below.



Tuesday, July 19 Events

| | | |
|------------|---|---------------------|
| 8:30 a.m. | Plenary - Strategies for Sustaining Global Food and Water Supplies | Regency Ballroom |
| 10:00 a.m. | Morning Break, Exhibits and Posters Open | Ambassador Ballroom |
| 10:30 a.m. | Concurrent Sessions - Schedule on page 27 Regency, Diplomat, Executive, Palladian, Forum, Congressional A, Congressional B, Cabinet, Empire, Senate, & Council | |
| 11:00 a.m. | ARSCSE Lunch * & Annual Business Meeting | Director's Room |
| Noon | Lunch Break – Awards Luncheon * or On Your Own | Diplomat Ballroom |
| 1:30 p.m. | Concurrent Sessions - Schedule on page 28 Regency, Diplomat, Executive, Palladian, Forum, Congressional A, Congressional B, Cabinet, Empire, Senate, & Council | |
| 3:00 p.m. | Afternoon Break, Exhibits and Posters Close at 3:30 | Ambassador Ballroom |
| 3:30 p.m. | Concurrent Sessions - Schedule on page 29 Regency, Diplomat, Executive, Palladian, Forum, Congressional A, Congressional B, Cabinet, Empire, Senate, & Council | |

Tuesday Event Descriptions

Tuesday Plenary: Strategies for Sustaining Global Food and Water Supplies

Tuesday, July 19 • 8:30 a.m. – 10:00 a.m.
Regency Ballroom

This plenary session will focus on food supply and water as two of our most critical global resources. Our accomplished panel will address issues central to our work, including 1) the challenges and opportunities associated with increasing agricultural production without compromising water quality and supply for other uses; 2) what we can learn from different approaches to food production and soil and water conservation; and 3) interactions between global programs and policies and local conservation efforts.

Panelists:

- Rob Bertram – Chief, Multi-Lateral Programs Division of the Center for Economic Growth and Agricultural Development, USAID
- Ann Mills – Deputy Under Secretary for Natural Resources and Environment, USDA
- Mihaela Popovici – International Commission for the Protection of the Danube River (Vienna, Austria)

- Kitty Smith – Administrator, Economic Research Service
- Norman Uphoff – Cornell University
- Theo Dillaha – Virginia Tech (moderator)

Concurrent Sessions

Symposia and Oral Presentations

Tuesday, July 19 • 10:30 a.m. to Noon

Tuesday, July 19 • 1:30 p.m. to 3:00 p.m.

Tuesday, July 19 • 3:30 p.m. to 6:00 p.m.

See Pages 27-29 for the Tuesday schedules.

Awards Luncheon

Tuesday, July 19 • Noon – 1:30 p.m.
Empire Ballroom

Join us at the Awards Luncheon as we recognize the outstanding individuals, groups, and SWCS Chapters who have made significant contributions to SWCS and the conservation field.

Tickets for this event must be purchased no later than Noon on Monday, July 18 at the SWCS registration desk. Cost: \$65

Tuesday Plenary: Strategies for Sustaining Global Food and Water Supplies

The Tuesday morning plenary session will focus on two of our most critical global resources: food and water supplies. The distinguished panel will address 1) the need to increase agricultural production without compromising water quality and supply for other uses; 2) what we can learn from different approaches to food production and soil and water conservation; and 3) interactions between global programs and policies and local conservation efforts.

Panelists:



Dr. Mihaela Popovici is Technical Expert in Water Management and Pollution Control at the International Commission for the Protection of Danube River (ICPDR) in Vienna, Austria. Dr. Popovici holds a Ph.D. in hydraulics (Romania), two master degrees in civil engineering (Romania) and water management (Netherlands, USA OSU) and training in environmental economics (USA Harvard University). Dr Popovici is author of three books on environmental topics and of more than 300 of journal articles. Michaela.Popovici@unvienna.org



Ann Mills is the Deputy Under Secretary for Natural Resources and Environment, USDA and has responsibility for the Natural Resources Conservation Service (NRCS). Mills has 20 years of policy and management experience with government and nonprofit conservation advocacy. Most recently, as a senior executive at American Rivers, Mills led the implementation of programs to develop sustainable solutions for flood and drought mitigation and water quality improvement across the country including urban and rural watersheds in Northern California's Sierras and Bay Delta; the Columbia, Missouri and Mississippi river basins; the Great Lakes; and the Chesapeake Bay. She holds a Master's Degree from the Lyndon B. Johnson School of Public Affairs at The University of Texas at Austin, and a BA in Political Science from Tufts University. Ann.Mills@osec.usda.gov



Dr. Norman Uphoff is Professor of Government and International Agriculture and Director Cornell Institute for Public Affairs, Cornell University. Formerly Director of the Cornell International Institute for Food, Agriculture and Development (CIIFAD), 1990-2005, and chief editor of a book on Biological Approaches to Sustainable Soil Systems, CRC Press, 2006. He is currently, senior advisor for the SRI International Network and Resources Center at Cornell University, which provides information and promotes research and evaluation on the System of Rice Intensification (SRI), an agroecological methodology that enables farmers to raise their yields of rice (and other crops) with less input required of water, fertilizer and other agrochemicals. ntu1@cornell.edu



Katherine (Kitty) Smith is the Administrator of USDA's Economic Research Service. As a researcher and research manager, Dr. Smith's principal areas of expertise have been policy analysis, particularly agricultural and resource policy integration, and the relationships among agricultural production and environmental quality. Her landmark work on past inconsistencies between commodity and conservation policies and improved performance possibilities for a brand new Conservation Reserve Program paved the way for important enhancements in U.S. conservation policies and programs. KSMITH@ers.usda.gov



Dr. Rob Bertram is Director of the USAID Bureau for Food Security's Office of Agricultural Research and Transformation. Rob has been with USAID for more than 20 years, and comes from a plant breeding and genetics background, with degrees from UC Davis, the University of Minnesota and the University of Maryland. His doctoral work focused on molecular techniques in assessing plant genetic resources and evolution in the genus that includes cassava. rbertram@usaid.gov



Dr. Theo Dillaha is a Professor of Biological Systems Engineering at Virginia Tech and a former President of the Soil and Water Conservation Society. At Virginia Tech he conducts research and teaches in soil and water conservation engineering. He has worked in over 20 countries addressing natural resource management issues. dillaha@vt.edu



Learn more about the 4Rs at the Poster Symposium!
Tuesday, July 19 - 10:30 a.m. to 12:00 P.M. in the Regency Ballroom

4R NUTRIENT STEWARDSHIP

4R nutrient stewardship provides a framework to achieve cropping system goals – increased production, increased farmer profitability, and enhanced environmental protection. To achieve those goals the 4Rs utilize fertilizer best management practices that address the Right Nutrient Source, at the Right Rate, the Right Time, and in the Right Place. The four “rights” are necessary for sustainable plant nutrition management. The assessment of any planned nutrient management practice must consider the economic, social, and environmental effects to determine whether or not it is a “right” practice for that system.

4R Universal Scientific Principles

The 4R nutrient stewardship principles are the same globally, but how they are used locally varies depending on field and site specific characteristics such as soil, cropping system, management techniques and climate.

RIGHT SOURCE

Ensure a balanced supply of essential nutrients, considering both naturally available sources and the characteristics of specific products in plant available forms. Specifically – consider nutrient supply in plant available forms, ensure nutrient suits soil properties, and recognize the synergisms among elements.

RIGHT RATE

Assess and make decisions based on soil nutrient supply and plant demand. Specifically – appropriately assess soil nutrient supply (including those from organic sources and existing soil levels), assess plant demand, and predict fertilizer use efficiency.

RIGHT TIME

Assess and make decisions based on the dynamics of crop uptake, soil supply, nutrient loss risks, and field operation logistics. Specifically – assess the timing of crop uptake, assess the dynamics of the soil's nutrient supply, recognize weather factors, and consider logistics.

RIGHT PLACE

Address root-soil dynamics and nutrient movement, and manage spatial variability within the field to meet site-specific crop needs and limit potential losses from the field. Specifically – recognize root – soil dynamics, manage spatial variability issues, consider the tillage system, and limit potential off-field transport.

To help identify opportunities to improve fertilizer efficiency and prevent nutrient movement from each field, ask:

Was the **RIGHT FERTILIZER SOURCE**
given to the crop at the **RIGHT RATE**,
RIGHT TIME, and in the
RIGHT PLACE?



The new www.nutrientstewardship.com website promotes the 4R philosophy, an innovative and science-based approach that offers enhanced environmental protection, increased production, increased farmer profitability, and improved sustainability.

Learn more about 4R nutrient stewardship
at www.nutrientstewardship.com.

The United States Department of Agriculture Natural Resource Conservation Service (USDA NRCS) has been undertaking Conservation Effectiveness Assessment Program (CEAP) studies in major watersheds throughout the United States. Key findings indicate **that suites of best management practices work better than single practices**, and that there is a need to **increase the complete and consistent use of nutrient management**, defined as using strategies that address proper **rate, form, timing, and placement**.

Wednesday, July 20 Events

| | | |
|-----------|--|--------------------|
| 7:30 a.m. | Educational Tours #1, #2, & #4 * | Main Hotel Lobby |
| 8:30 a.m. | Educational Tours #3 & #5 * | Main Hotel Lobby |
| 8:30 a.m. | Farm Bill Forum * | Palladian Ballroom |
| Noon | Farm Bill: Paying for Performance Workshop * | Palladian Ballroom |

Continues on Thursday, July 21

Wednesday Events Descriptions

Outdoor Classroom – Educational Tours

Wednesday, July 20 • Departure and return times vary. All busses and vans will leave from the front entrance of the hotel.

Gather in main hotel lobby by 7:15 a.m. for 7:30 departures; 8:15 a.m. for 8:30 departures. If tickets are available, you may purchase them at registration until Noon on Tuesday.

Meet in the main lobby to find your tour group. All tours include lunch.

(1) National Arboretum; Plant Material Center; ARS Beltsville Farm; and National Agricultural Laboratory. (\$75)

7:30 a.m. departure

(2) Anacostia River restoration and Kenilworth Gardens. (\$105)

7:30 a.m. departure

(3) Harry R. Hughes Center for Agro-Ecology and Chesapeake Bay farm and research center. (\$75)

8:30 a.m. departure

(4) George Washington's Mount Vernon Estate and Gardens (\$92)

7:30 a.m. departure

(5) Congressional Research Service and House/Senate Agriculture Committee visit and U.S. Botanic Garden (\$75)

8:30 a.m. departure

Tour #1: National Arboretum, NRCS Plant Materials Center, ARS Beltsville Research Farm

Stop 1: The U.S. National Arboretum was established in 1927 by an Act of Congress. The Arboretum is administered by the U.S. Department of Agriculture's Agricultural Research Service to serve the public need for scientific research, education, and gardens that conserve and showcase plants to enhance the environment. This tour will include a visit through the major garden features including aquatic plants, the Fern Valley Native Plant Collections, the National Grove of State Trees, and the National Herb Garden.

Stop 2: Established in 1939, the Norman A. Berg Plant Materials Center primarily focuses on national initiatives and provides coordination and assistance for Plant Materials work across all 50 states. Beyond national duties, the Center has developed plants and technology to help conserve natural resources in the Mid-Atlantic region.

Stop 3: National Visitor Center (NVC) at the ARS Beltsville Agricultural Research Center and Farm hosts about 6,000 visitors each year from around the world. Visitors include policymakers, managers, and scientists from U.S. and international governments, universities, and industry. Being located on the grounds of the Henry A. Wallace Beltsville Agricultural Research Center (BARC) with ARS headquarters staff nearby, the tour will offer an overview of research of interest to SWCS visitors. This research center is the largest most comprehensive research center of its kind in the world.

Stop 4: The final stop on the tour will be the National Agricultural Library, containing one of the world's largest and most accessible agricultural information collections. Learn about NAL and its services with a guided tour of the library. The tour includes a stop in the library's Special Collections unit, which houses rare books, manuscript collections, nursery and seed trade catalogs, photographs, and posters.

Tour #2: Anacostia River restoration and Kenilworth Gardens tour

The eight-mile Anacostia River runs south from the District of Columbia through Maryland and into the Chesapeake Bay, flowing through one of the nation's most developed metropolitan areas. The U.S. Environmental Protection Agency (EPA), the District of Columbia, and the state of Maryland announced a new total maximum daily load (TMDL) for trash in the Anacostia River, making it the first interstate river in the nation with a Clean Water Act trash limit. The tour will include classroom discussion, in the Anacostia Watershed Society's 18th century restored tavern office, an overview of the Anacostia River and watershed and AWS work of the followed by 1 of 3 options, and a trip on pontoon boats on the Anacostia River. Tour limit 30.

Tour #3: Harry R. Hughes Center for Agro-Ecology & Chesapeake Bay Farm and Research Center

The Hughes Center, named for the former Democratic governor, had its beginnings in the infamous "pfiesteria hysteria" of 1997; i.e., toxic species of algae that bloomed in Eastern Shore rivers. The Hughes Center is a nonprofit organization that is under the umbrella of the University of Maryland. The Center seeks to identify the knowledge gaps that exist concerning pollution inputs to the Bay that we need to fill to answer a policy question?" The Center looks for projects that can answer those questions in the short term. We will learn about some of the major natural resources protection projects taking place on the Chesapeake Bay.

Tour #4: George Washington's Mount Vernon Estate and Gardens

Just as he led his countrymen on the field of battle and in the executive office, Washington was a leader in the development of American agriculture. The same calm determination Washington showed under fire was evident in his constant experimentation and efforts to improve the productivity of his four working farms.

By constant experimentation, he was able to improve the quality of his soil through a crop rotation system, fertilizers, and other land conservation techniques. He modified tools and methods to suit his needs, and he transformed Mount Vernon into a diversified farm, where he grew wheat, corn, potatoes, buckwheat, oats, and rye. He also planted grasses in hopes that his soil would remain fertile year after year. Perhaps his most dramatic invention was a 16-sided treading barn for processing wheat and other grains, which he had built on his Dogue Run Farm. Participants will spend approximately 30 minutes in Washington's home and approximately 3 - 4 hours taking in panoramic views, visiting Washington's tomb, seeing the innovative Pioneer Farmer site, and much more.

Tour #5: Congressional Research Service, House or Senate Ag Committee visit, U.S. Botanic Garden

This tour is a replication of a very successful and popular tour that the SWCS National Capitol Chapter held for local members 2 years ago. Participants will learn about Congressional Research Service ag issues, resources, publications, and visit with senior staff members on the House or Senate Ag Committee. The last stop will be a visit to the U.S. Botanic Garden for a "behind the scenes" tour.

Soil and Water Conservation Society – 66th International Annual Conference

| Monday | 10:30 a.m. | 10:50 a.m. | 11:10 a.m. | 11:30 a.m. |
|---|--|---|--|---|
| Council Room <i>Conservation Tools & Technologies Track</i> | Conewago Watershed Information Technology Platform <i>Jeremy Zidek, ZedX Inc.</i> | Developing a Place-Based Tool for Evaluating the Cost Effectiveness of Beneficial Management Practices <i>Yongbo Liu, Department of Geography, University of Guelph</i> | Development and Application of a Tool for Water Quality Trading and Assessment <i>Ali Saleh, TIAER</i> | Evaluation of a Prioritization Process for Targeting Conservation Practices to Benefit Groundwater Recharge and Sedimentation <i>John Legge, The Nature Conservancy</i> |
| Senate Room <i>Soil & Water Track</i> | Beneficial Use For Water Plant Residuals (Alum Land Application) <i>Mitch Turner Water Resource Manager, SJWD Water District</i> | Land use and climate change effects on watershed commons in the Albertine Rift Valley of Africa <i>Simon Nampindo, University of Massachusetts</i> | Water flow patterns over 70 years after reforestation of the Ganaraska River Headwaters, South-central Ontario <i>Hida Manns, University of Guelph</i> | Adoption of Fertilizer versus Manure in Pakistan <i>Sarah Ali, University of Missouri-Columbia</i> |
| Forum Room <i>Conservation Policy Track</i> | The Mississippi River Basin Initiative in the Boone River Watershed, Iowa: Lessons Learned from Year One Implementation and Monitoring <i>Eileen Bader, The Nature Conservancy</i> | Conservation Stewardship Program: Understanding its Current Decision Framework and Suggesting Improvements <i>Richard L. Farnsworth, NRCS/USDA</i> | 2012 Farm Bill: Crop Insurance and Conservation Compliance <i>Brad Redlin, Izaak Walton League of America</i> | National Cooperative Soil Survey-Recommendations from 2011 (Work Planning) Conference <i>Paul Benedict, USDA-Natural Resources Conservation Service</i> |
| Cabinet Room <i>Water Track</i> | Water Use and Irrigation Management of Switch Grass, Silage Corn and Sorghum for Biofuel Feedstock in the Arid Pacific Northwest USA <i>Romulus O. Okwany, Washington State University</i> | Water Quality in the Fort Cobb Watershed, USA: Spatial and Temporal Patterns of Sediment Concentration <i>Jean L. Steiner, USDA-ARS</i> | Water Quality in the Fort Cobb Watershed, USA: Spatial and Temporal Patterns of Dissolved P Stream Concentrations <i>Dory H. Franklin</i> | Differential leaching of phosphorus from litter-amended soils of the Delmarva Peninsula <i>Peter Kleinman, USDA-ARS PSWMRU</i> |
| Congressional A | #2. Anatomy of a Conservation Partnership for Integrated Watershed Restoration (Kristin Saacke Blunck, Penn State Cooperative Extension) | | | |
| Congressional B | #5. Conservation Treatment Needs for Cropland Identified by the Conservation Effects Assessment Project (CEAP) (Arnold King, Texas A&M Agrilife Research) | | | |
| Empire | #10. EPA Programs and Implementation Collaboration Now and in the Future (Katie Flahive, US Environmental Protection Agency) | | | |
| Palladian | #1. Agricultural commodity support programs and their effects on markets, the environment, and developing countries (SWCS International Committee) | | | |
| Executive | #17. Cooperative Conservation Partnership Initiative Projects (Jimmy Daukas, American Farmland Trust) | | | |
| Regency | #24. The Farm Bill and Climate Change (Eliav Bitan, National Wildlife Federation) | | | |
| Diplomat | NRCS Conservation Innovation Grants Showcase | | | |

Soil and Water Conservation Society – 66th International Annual Conference

| Monday | 1:30 p.m. | 1:50 p.m. | 2:10 p.m. | 2:30 p.m. |
|---|---|--|--|---|
| Council Room <i>Conservation Tools & Technologies Track</i> | Nutrient cycling trade-offs associated with manure application methods <i>Emily Duncan, Pennsylvania State University</i> | Development of a forecasting tool to guide field management decisions related to fertilizer and manure <i>Anthony Buda, USDA-ARS</i> | Targeting Watersheds for Nitrogen Reduction Practices <i>Ralph Heimlich, Agricultural Conservation Economics</i> | The AgES-NLEAP Tool for Precision Nitrogen Conservation Management <i>James C. Ascough II, USDA-ARS, Agricultural Systems Research Unit</i> |
| Senate Room <i>Soil Track</i> | Assessing the Impact of Long-term Cultivation on Runoff, Pollutant Loads, and Crop Yields <i>Claire Baffaut, USDA-ARS-CSWQRU</i> | Cover Crops Enhance No-Till Potential to Improve Soil Properties and Store Carbon in the Central Great Plains <i>Humberto Blanco, Kansas State University</i> | Native Perennial Plant Impacts to Soil Water Characteristics: A Review <i>Scott Dierks, PE JFNew</i> | |
| Forum Room <i>Conservation Policy Track</i> | Perverse Incentives for Adaptation to Climate Change in Latin America <i>Cornelia Butler Flora Iowa State University</i> | Agricultural Greenhouse Gas Offset System Experiences <i>Tom Goddard, Alberta Agriculture and Rural Development</i> | Tools and Markets Leading to Soil Conservation in Canada <i>Don McCabe, President, Soil Conservation Council of Canada</i> | How Farmers Adapt to Structural and Regional Shifts Induced by Climate Change: <i>Richard Nehring, ERS</i> |
| Cabinet Room <i>Water Track</i> | The Chippewa 10% Project: Making Needed Ecosystem Services Pay In An Agricultural Watershed <i>George Boody, Land Stewardship Project</i> | Restoring Instream Flow to Critical Western Waterways Through Market-based Investments and Transactions; Lessons Learned and Future Opportunities for NRCS and SWCDs <i>Andrew Purkey, National Fish and Wildlife Foundation</i> | Community Outreach Activities on Drinking Water Quality Monitoring, Drinking Water Sterilization and Management in Majuro, Marshall Islands <i>Gulnihal Ozbay, Delaware State University</i> | Chesapeake Bay Foundation's Buffer Bonus Program for Farmers <i>David Wise, Chesapeake Bay Foundation</i> |
| Congressional A | #7. Choptank River Watershed Project: Advancing Science to Improve Conservation and to Reduce Risk (Cathleen Hapeman and Greg McCarty, USDA-ARS) | | | |
| Congressional B | #6. HUMUS Findings - A national/regional summary of water quality results (Arnold King, Texas A&M, AgriLife Research) | | | |
| Empire | #26. Using Nonpoint Source Stories to Communicate Water Quality Successes (Rebecca Roose, US EPA) | | | |
| Palladian | #18. Pollinators and Pollination Services: Technology Development, Policy, and Action (Cheryl Simmons, USDA-NRCS) | | | |
| Executive | #23. Targeting Phosphorus Reduction in Small-Scale Agricultural Watersheds: Lessons from Wisconsin (Pete Nowak, University of Wisconsin-Madison) | | | |
| Regency | #8. Conservation Practices to Mitigate and Adapt to Climate Change (Jorge A Delgado USDA ARS) | | | |
| Diplomat | NRCS Conservation Innovation Grants Showcase | | | |

The abstract book for the conference is online as a pdf file at www.swcs.org/11ac

Soil and Water Conservation Society – 66th International Annual Conference

| Monday | 3:30 p.m. | 3:50 p.m. | 4:10 p.m. | 4:30 p.m. | 4:50 p.m. |
|---|---|---|--|--|---|
| Council Room <i>Conservation Tools & Technologies Track</i> | The Land Between Two Rivers and the Art of Negotiation <i>David R. Speidel USDA - Foreign Agriculture Service</i> | Effects of weirs on sediment accumulation, pH, and phosphorus retention in agricultural drainage ditches over time <i>Elizabeth Usborne, Mississippi State University</i> | Updated invasive Phragmites mapping methods and results for the Great Lakes region <i>Liza Jenkins, MTRI</i> | 4R Nutrient Stewardship to Balance Fertilizer Price Risk and Optimize Yield and Profitability <i>Steve Phillips, Director, Southeast United States, International Plant Nutrition Institute</i> | |
| Senate Room <i>Urban Conservation Track</i> | Achieving Turbidity Control on Real Construction Sites, or Not <i>Richard McLaughlin, North Carolina State University</i> | Contracts for Sustainable Management of Agriculture Land: Benefit Estimates on Preservation and Conservation from a Choice Experiment <i>Allison M. Borchers, Economic Research Service, USDA</i> | GreenPlan: Accounting for Ecosystem Services Conservation in Urbanizing Areas <i>Eileen McLellan, Environmental Defense Fund</i> | Ecological Engineering on the China Three Gorges University Campus: Managing Runoff from a Well-Integrated Landscape <i>David M. Johnson, Ferrum College, Ferrum Virginia</i> | Linking watershed modeling to local land management in a coastal community <i>Kathy Boomer, Smithsonian Environmental Research Center</i> |
| Forum Room <i>Soil Track</i> | Spatial Soil Sampling Design to Optimize Accurate Assessment of Soil Carbon Stocks at an AmeriFlux Site in Iowa <i>Thomas J. Sauer, National Laboratory for Agriculture and the Environment</i> | Sediment sources in the upper reaches of a Valley and Ridge watershed <i>John P. Schmidt, USDA - ARS</i> | Ecological Site Description for Crop and Pasture Lands <i>Susan S. Andrews, USDA NRCS National Soil Survey Center</i> | Land-use and Climate Change Effects on Northern Leopard Frog Habitat Suitability in North Dakota <i>David Mushet, U.S. Geological Survey, Northern Prairie Wildlife Research Center, Jamestown, ND</i> | |
| Cabinet Room <i>Water Track</i> | Analyses of Precipitation and Floods in Goodwater Creek Experimental Watershed <i>E. John Sadler, USDA-ARS</i> | Soil and water conservation under climatic stress in selected watersheds in Russia <i>Olga Tsvetkova, University of Massachusetts</i> | An Integrated Social and Ecological Modeling Approach to the Impacts of Agricultural Conservation Practices on Water Quality <i>Irem Daloglu, University of Michigan</i> | Tools for Climate and Water Resources Management: A Kiwi Initiative <i>M.S. Srinivasan, National Institute of Water & Atmospheric Research Limited, New Zealand</i> | Soil conservation and water recycling for irrigation in Hassa oasis, eastern Saudi Arabia <i>Nasser A. Alsaaran, King Saud University</i> |
| Congressional A | #7. Choptank River Watershed Project: Advancing Science to Improve Conservation and to Reduce Risk (Cathleen Hapeman and Greg McCarty, USDA-ARS) Continued | | | | |
| Congressional B | #12. Fish and Wildlife Conservation: Emerging Findings from the CEAP Wildlife Component (Charles Rewa, USDA NRCS) | | | | |
| Empire | #9. Environmental Outcomes of Conservation Practices applied to Grazing Lands (Mark Weltz, USDA-ARS) | | | | |
| Palladian | #18. Pollinators and Pollination Services: Technology Development, Policy, and Action (Cheryl Simmons, USDA-NRCS) Continued | | | | |
| Executive | #23. Targeting Phosphorus Reduction in Small-Scale Agricultural Watersheds: Lessons from Wisconsin (Pete Nowak, University of Wisconsin-Madison) Continued | | | | |
| Regency | #8. Conservation Practices to Mitigate and Adapt to Climate Change (Jorge A Delgado USDA ARS) Continued | | | | |

Soil and Water Conservation Society – 66th International Annual Conference

| Tuesday | 10:30 a.m. | 10:50 a.m. | 11:10 a.m. | 11:30 a.m. |
|--|---|--|---|---|
| Council Room <i>Education and Outreach Track</i> | Farmers and Agency Perspectives About Conservation: Lessons from the NIFA-CEAP Key Informant Survey <i>Deanna L. Osmond, NC State University</i> | Dairy Farm Energy and Related Greenhouse Gas Reporting Tool <i>Jennifer Brinker, GDS Associates, Inc.</i> | | |
| Senate Room <i>Soil Track</i> | Metolachlor-ESA as a marker for nitrate flux in a first-order stream and riparian zones. <i>Clifford P. Rice, USDA, Agricultural Research Service</i> | SEM Measured Spatial Variability of Soil Carbon as Influenced by Management <i>Clark J. Gantzer, University of Missouri</i> | Soil loss evaluation index application and comparison with RUSLE: a case study in the Loess Plateau of China <i>Zhao Wenwu, Beijing Normal University</i> | |
| Cabinet Room <i>Water Track</i> | Conservation strategies to reduce nutrient loading in Lake Egridir Watershed of Turkey <i>Ayten Erol, Suleyman Demirel University</i> | Effects of Riparian Buffers on Nitrate Concentrations in Watershed Discharges: New Models and Management Implications <i>Donald E. Weller, Smithsonian Environmental Research Center</i> | Seep and Stream Nitrogen Dynamics in two adjacent Mixed Land Use Watersheds <i>Mark Williams, Penn State University</i> | Potential Effects Of Water Regime And Organic Fertilization On Nitrogen Leaching In Ne Italy. A Lysimeter Study. <i>Francesco Morari, Department of Environmental Agronomy, University of Padova, Italy</i> |
| Congressional A | #27. Verification and Continuous Improvement of Conservation Performance for Water Quality Protection (Tom Simpson, Water Stewardship, Inc) | | | |
| Congressional B | #19. Producer Perspectives on Conservation (Gretchen Kamps, Pioneer Farm) | | | |
| Forum | #21. Selecting Area-wide and Site-Specific Conservation Activities: Some Policy and Economic Considerations on their Cost Effectiveness (Felix Spinelli, USDA-NRCS) | | | |
| Palladian | #22. Soil and Water Touch Points for Sustainability Standards (Michelle Wander, University of Illinois) | | | |
| Executive | #16. The National Climate Assessment - Science, Processes, and Products (Emily Cloyd, US Global Change Research Program) | | | |
| Regency | Special Poster Sessions <ul style="list-style-type: none"> Utilizing the 4R Nutrient Stewardship Framework (Lara Moody, The Fertilizer Institute) Conservation Practices to Mitigate and Adapt to Climate Change (Jorge A Delgado USDA ARS) | | | |
| Diplomat | NRCS Conservation Innovation Grants Showcase | | | |

The abstract book for the conference is online as a pdf file at www.swcs.org/11ac

Soil and Water Conservation Society – 66th International Annual Conference

| Tuesday | 1:30 p.m. | 1:50 p.m. | 2:10 p.m. | 2:30 p.m. |
|---|--|--|---|--|
| Council Room <i>Conservation Tools & Technologies Track</i> | Riparian Buffer Design Tool a Canadian Example <i>Kimberly Fomradas, Agriculture and Agri-Food Canada</i> | Validation of an Online Terrace Layout Program <i>Allen Thompson, University of Missouri</i> | Guidelines for polyacrylamide use for erosion control from soils of differing texture, pH, and clay mineralogy. <i>Clark J. Gantzer, University of Missouri</i> | The Secret's in the Roots: A multi-benefit planting regime for wetland sites. <i>Mike Thompson, Wetlands Forever, Inc.</i> |
| Senate Room <i>Soil Track</i> | Greater Sage Grouse Recovery Strategies with Montana Ranchers <i>Tim Griffiths, USDA NRCS, Montana</i> | The Menoken Farm: Making Mother Nature Show Her Hand <i>Richard M. Webb, USDA-NRCS</i> | The interrelationship of plants, moisture and soil carbon <i>Hida Manns, University of Guelph</i> | |
| Forum Room <i>Conservation Policy Track</i> | New Arkansas Water Plan: Integration of Economic and Conservation Policies <i>Kuatbay Bektemirov, University of Arkansas</i> | Computer model simulations of market-based policy targeting water quality conservation in an agricultural watershed in New Zealand <i>Timothy Cox, National Institute of Water and Atmospheric Research (NIWA)</i> | Water budgets and nutrient flows from subsurface tile in an agricultural landscape <i>Eric Cooley, UW-Discovery Farms</i> | Revisiting the U.S. Flood Control Program <i>Peter E. Black, SUNY ESF</i> |
| Congressional A | #3. Assessing Conservation Effects in Wetlands to Estimate Ecosystem Services (William Effland, USDA-NRCS) | | | |
| Congressional B | #15. Managed Grazing: The Forgotten Hero of Conservation (Laura Paine, WI Depart of Agriculture, Trade, & Consumer Protection) | | | |
| Palladian | #4. Bioenergy Production: Can Bioenergy Grow Our Energy Independence? (Lyn Kirschner, USDA-NRCS) | | | |
| Executive | #14. Innovation in Conservation Policy and Practice: The Case of the Conservation Stewardship Program (Greg Fogel, National Sustainable Agriculture Coalition) | | | |
| Regency | #20. Expanding Conservation Compliance: Options, Opportunities, and Challenges (Michelle Perez, World Resources Institute) | | | |
| Diplomat | NRCS Conservation Innovation Grants Showcase | | | |

Soil and Water Conservation Society – 66th International Annual Conference

| Tuesday | 3:30 p.m. | 3:50 p.m. | 4:10 p.m. | 4:30 p.m. | 4:50 p.m. | 5:10 p.m. |
|--|--|---|---|--|--|--|
| <p>Council Room Conservation Tools & Technologies Track</p> | <p>Adopting farming practices that improve rainfall harvesting Joe Bragger, Bragger Family Dairy - UW Discovery Farms Cooperator</p> | <p>Benefits of Conservation Practices on Nutrient Losses at the Field and Watershed Scale in the Western Lake Erie Basin Douglas R. Smith, USDA-ARS, NSERL</p> | <p>The Importance of Herbicides in Conserving Soil and Water Resources Leonard Cianessi, Crop Protection Research Institute, CropLife Foundation</p> | <p>Evaluating Runoff Predictions Between Rainfall Tables and Generalized Distribution Curves with WinTR-20 in New York State Peter Wright, Natural Resources Conservation Service</p> | <p>Transforming RUSLE2 with a GIS-Based User Interface and LiDAR Tom Buman, Agren</p> | <p>Two-Dimensional Distributed Soil Erosion Prediction with RUSLE2 Seth M. Dabney, USDA-ARS</p> |
| <p>Senate Room Adaptive Management Track</p> | <p>How farmers use real time soil moisture data to reduce manure runoff Mark Riechers, Riechers Beef - UW Discovery Farm Cooperator</p> | <p>Reducing Fertilizer and Water Needs with Sodbased Rotations Georgii Anguelov, University of Florida, IFAS-NFREC, Quincy</p> | <p>Feasibility of Financial Safety Net for Farmers to Deliver Substantial Gains in Conservation Adoption Thomas Green, BMP CHALLENGE</p> | <p>Bioinformatics for the Albertine Rift: A virtual research center for applied biodiversity in Rwanda, Africa Maxine Levin, USDA-Natural Resources Conservation Service</p> | <p>Lower Mekong Initiative-Linkages between Climate Change and Food Security Maxine Levin, USDA-Natural Resources Conservation Service</p> | |
| <p>Forum Room Conservation Policy Track</p> | <p>Alberta Land Stewardship Act Tom Goddard, Alberta Agriculture and Rural Development</p> | <p>When to stop? An economic analysis of bluegrass production under various residue management regimes Kathleen Painter, University of Idaho</p> | <p>Conservation Research and Extension in Croatia Mary Ann Rozum, USDA National Institute of Food and Agriculture</p> | <p>Organic Agriculture and Conservation: A Necessary but not Sufficient System for Improved Conservation Jef Schahczenski, National Center for Appropriate Technology</p> | <p>Identifying Quantity Trends in Agricultural Chemical Use for Soybean Production Using State Research Verification Program Historical Data C. Robert Stark, Jr., University of Arkansas at Monticello School of Agriculture</p> | <p>Soil and water conservation sciences, policies and practices: Perspectives and Applications in the Chinese Loess region Wei Wei, Research Center for Eco-environmental Sciences, Chinese Academy of Sciences</p> |
| <p>Congressional A</p> | <p>#28. An Overview of the Mid-Atlantic Regional Wetland Conservation Effects Assessment Project (Megan Lang, USDA-FS)</p> | | | | | |
| <p>Congressional B</p> | <p>#15. Managed Grazing: The Forgotten Hero of Conservation (Laura Paine, WI Depart of Agriculture, Trade, & Consumer Protection) <i>Continued</i></p> | | | | | |
| <p>Cabinet</p> | <p>#25. Transborder Water Resources Management (Jim Bruce and Melinda McClanahan, SWCS International Committee)</p> | | | | | |
| <p>Empire</p> | <p>#13. Implementing adaptive management and valuing ecosystem services in national water resource policy and law (Steve Young, University of Nebraska-Lincoln)</p> | | | | | |
| <p>Palladian</p> | <p>#4. Bioenergy Production: Can Bioenergy Grow Our Energy Independence? (Lyn Kirschner, USDA-NRCS) <i>Continued</i></p> | | | | | |
| <p>Executive</p> | <p>#14. Innovation in Conservation Policy and Practice: The Case of the Conservation Stewardship Program (Greg Fogel, National Sustainable Agriculture Coalition) <i>Continued</i></p> | | | | | |
| <p>Regency</p> | <p>#11. Evaluations of the current state of agricultural nitrogen use and cost-effective means of reducing environmental impacts (LeRoy Hansen, USDA-ERS)</p> | | | | | |

Soil and Water Conservation Society – 66th International Annual Conference

| Symposia Number | Symposia Title (Organizer) |
|------------------------|--|
| 1 | Agricultural commodity support programs and their effects on markets, the environment, and developing countries (SWCS International Committee) |
| 2 | Anatomy of a Conservation Partnership for Integrated Watershed Restoration (Kristin Saacke Blunck, Penn State Cooperative Extension) |
| 3 | Assessing Conservation Effects in Wetlands to Estimate Ecosystem Services (William Effland, USDA-NRCS) |
| 4 | Bioenergy Production: Can Bioenergy Grow Our Energy Independence? (Lyn Kirschner, USDA-NRCS) Two Block Symposium |
| 5 | Conservation Treatment Needs for Cropland Identified by the Conservation Effects Assessment Project (CEAP) (Arnold King, Texas A&M AgriLife Research) |
| 6 | HUMUS Findings - A national/regional summary of water quality results (Arnold King, Texas A&M, AgriLife Research) |
| 7 | Choptank River Watershed Project: Advancing Science to Improve Conservation and to Reduce Risk (Cathleen Hapeman and Greg McCarty, USDA-ARS) Two Block Symposium |
| 8 | Conservation Practices to Mitigate and Adapt to Climate Change (Jorge A Delgado USDA ARS) Two Block Symposium |
| 9 | Environmental Outcomes of Conservation Practices applied to Grazing Lands (Mark Wertz, USDA-ARS) |
| 10 | EPA Programs and Implementation Collaboration Now and in the Future (Katie Flahive, US Environmental Protection Agency) |
| 11 | Evaluations of the current state of agricultural nitrogen use and cost-effective means of reducing environmental impacts (LeRoy Hansen, USDA-ERS) |
| 12 | Fish and Wildlife Conservation: Emerging Findings from the CEAP Wildlife Component (Charles Rewa, USDA NRCS) |
| 13 | Implementing adaptive management and valuing ecosystem services in national water resource policy and law (Steve Young, University of Nebraska-Lincoln) |
| 14 | Innovation in Conservation Policy and Practice: The Case of the Conservation Stewardship Program (Greg Fogel, National Sustainable Agriculture Coalition) Two Block Symposium |
| 15 | Managed Grazing: The Forgotten Hero of Conservation (Laura Paine, WI Depart of Agriculture, Trade, & Consumer Protection) Two Block Symposium |
| 16 | The National Climate Assessment - Science, Processes, and Products (Emily Cloyd, US Global Change Research Program) |
| 17 | Cooperative Conservation Partnership Initiative Projects (Jimmy Daukas, American Farmland Trust) |

Soil and Water Conservation Society – 66th International Annual Conference

| Symposia Number | Symposia Title (Organizer) |
|------------------------|--|
| 18 | Pollinators and Pollination Services: Technology Development, Policy, and Action (Cheryl Simmons, USDA-NRCS) Two Block Symposium |
| 19 | Producer Perspectives on Conservation (Gretchen Kamps, Pioneer Farm) |
| 20 | Expanding Conservation Compliance: Options, Opportunities, and Challenges (Michelle Perez, World Resources Institute) |
| 21 | Selecting Area-wide and Site-Specific Conservation Activities: Some Policy and Economic Considerations on their Cost Effectiveness (Felix Spinelli, USDA, NRCS) |
| 22 | Soil and Water Touch Points for Sustainability Standards (Michelle Wander, University of Illinois) |
| 23 | Targeting Phosphorus Reduction in Small-Scale Agricultural Watersheds: Lessons from Wisconsin (Pete Nowak, University of Wisconsin-Madison) Two Block Symposium |
| 24 | The Farm Bill and Climate Change (Eliav Bitan, National Wildlife Federation) |
| 25 | Transborder Water Resources Management (Jim Bruce and Melinda McClanahan, SWCS International Committee) |
| 26 | Using Nonpoint Source Stories to Communicate Water Quality Successes (Rebecca Roose, US EPA) |
| 27 | Verification and Continuous Improvement of Conservation Performance for Water Quality Protection (Tom Simpson, Water Stewardship, Inc) |
| 28 | An Overview of the Mid-Atlantic Regional Wetland Conservation Effects Assessment Project (Megan Lang, USDA-FS) |
| Poster | Utilizing the 4R Nutrient Stewardship Framework (Lara Moody, The Fertilizer Institute) |
| Poster | Conservation Practices to Mitigate and Adapt to Climate Change (Jorge A Delgado USDA ARS) |

Notes

Soil and Water Conservation Society – 66th International Annual Conference

2011 Conservation Innovation Grants Showcase

July 18-19, 2011. Washington, DC

Diplomat Ballroom

Monday July 18, 2011

| | | |
|----------|--|--|
| | Moderator | Lillian Woods , National Technology Support Coordinator, NRCS, Washington, DC |
| 10:30 AM | Welcome | Dave White , Chief, NRCS, Washington, DC Bill Boyer , President, SWCS C. Wayne Honeycutt , Ph.D., Deputy Chief for Science and Technology, NRCS, Washington DC Anthony Kramer , Deputy Chief for Financial Assistance and Community Development, NRCS, Washington, DC Douglas Lawrence , Deputy Chief for Soil Survey and Resource Assessment, NRCS, Washington, DC |
| 11:30 AM | Farmers Conservation Alliance and the Farmers Screen | Julie O'Shea , Farmers Conservation Alliance |
| 12:00 PM | Lunch | |
| | Moderator | |
| 1:30 PM | Farming for Wildlife: Creating habitat rotations on working farms | Kris Knight , The Nature Conservancy |
| 2:00 PM | Forest Biomass Retention and Harvesting Guidelines for the Northeast | Robert Perschel , Forest Guild |
| 2:30 PM | Forest Makeover: Expanding the Local Knowledge of Sustainable Forest Management in the Appalachian Hardwood Region of Virginia | David Richert , Virginia Department of Forestry |
| 3:00 PM | Break | |
| | Moderator | |
| 3:30 PM | Council on Sustainable Biomass Production -- Findings and Outlook | John Heissenbuttel , Council on Sustainable Biomass Production |
| 4:00 PM | A Field Demonstration of Biochar Farming and Production Using Mobile Pyrolysis Technology | Richard Perritt , NC Farm Center for Innovation and Sustainability |
| 4:30 PM | Adjourn | |

Soil and Water Conservation Society – 66th International Annual Conference

2011 Conservation Innovation Grants Showcase
July 18-19, 2011. Washington, DC

Tuesday July 19, 2011

| | | |
|----------|--|---|
| | Moderator | |
| 10:30 AM | Conservation Certification: Assurances for the Absentee Landowner | Jamie Ridgely , Agren |
| 11:00 AM | Evaluating Sagebrush Mitigation Metrics as a Potential Credit Trading Tool | Jonathan Haufler , Ecosystem Management Research Institute |
| 11:30 AM | From Concept to Implementation: The Story of the Northern Everglades -Payment for Environmental Services Program | Sarah Lynch , World Wildlife Fund |
| 12:00 PM | Lunch | |
| | Moderator | |
| 1:30 PM | Driving Conservation Innovation and Sustainable Winegrowing Adoption through Performance Benchmarking, Tools and Resources | Allison Jordan , California Sustainable Winegrowing Alliance |
| 2:00 PM | Optimizing Conditions for Phosphorus Removal from Anaerobically Digested Dairy Manure | Joe Harrison , Washington State University |
| 2:30 PM | Pesticide Risk Mitigation Engine (PRiME) | Wade Pronschinske , IPM Institute of North America |
| 3:00 PM | Break | |
| 3:30 PM | Mitigating Manure Contaminated Drain Discharge with Controlled Drainage | Larry Geohring , Cornell University |
| 4:00 PM | Preliminary results from Agricultural Drainage Water Management CIG Projects in Ohio | Norman Fausey , USDA, ARS, MWA, Soil Drainage Research Unit |
| 4:30 PM | Adjourn | |

For more information about the Conservation Innovations Grant program, please contact:
Gregorio Cruz, CIG National Program Manager
USDA–Natural Resources Conservation Service
Phone: (202) 720–2335
Gregorio.Cruz@wdc.usda.gov

Soil and Water Conservation Society – 66th International Annual Conference

2011 Conservation Innovation Grants Showcase
July 18-19, 2011. Washington, DC

Poster Presentations

| | |
|---|---|
| Solving the Water Crisis in the Russian River with independent science and grower involvement | Laurel Marcus , CA Land Stewardship Institute |
| Policy and Ecology: A Rubric for Selecting Locally Native Seed Stock for Use on Maryland Roadsides | Sara Tangren , Chesapeake Natives |
| Development and Application of an Economic Anaerobic Digester Optimization (ADOPT) Model | Shannon Neibergsq , SES Washington State University |
| Precision Summer and Fall Seeded Cover Crop Impacts on Corn Productivity and Soil Health in No-Till Production Systems of the Northern Great Plains | Cheryl Reese , South Dakota State University |
| Cellulosic feedstock production in fields of complex topography. | Kurtis Reitsma , South Dakota State University |
| Developing Metrics to Measure On- and Off-Farm Sustainability Performance: The Stewardship Index for Specialty Crops | Andrew Arnold , SureHarvest |
| Project Find and Assit: Reaching Out to underserved small-scale landowners | Dennis Pate , Validus |
| Trials and Tribulations in the Adoption of a Systems Approach to Precision Nutrient Management Technology | Craig Yohn , West Virginia University Extension Service |
| Boone and Raccoon River Watershed Cooperative Conservation Project | Todd Sutphin , Iowa Soybean Association |
| An Integrated Approach to Conservation and Integrated Pest Management in Oklahoma Cropping Systems | Jeff Edwards , Oklahoma State University |
| Rapid Assessment of Carbon Sequestration Potential in Cropland for the Oklahoma Carbon Program | Jason Warren , Oklahoma State University |
| Adapting to climate change through increased use in prescribed fire and community-based partnerships | Maria Gutierrez , Texas A&M Institute of Renewable Natural Resources |
| Removing Soluble Phosphorus from Agricultural Drainage Waters using FGD Gypsum Filters | Arthur Allen , University of Maryland Eastern Shore |
| Alternative Methods of Biofuel Production to Enhance Farm Profitability While Improving Wildlife and Soil and Water Conservation | Ray Wright , University of Missouri-Columbia (Bradford Research and Extension Center |

CIG posters are in the Diplomat Ballroom and will remain up throughout the conference.

CIG Poster Presenters, please have your posters down by 5:00 p.m. Tuesday afternoon so the NIFA presenters can use your boards. Thank you.

Symposia Descriptions

#1 Monday, 10:30 a.m. - Palladian

Agricultural commodity support programs and their effects on markets, the environment, and developing countries

Theo Dillaha, SWCS International Committee

dillaha@vt.edu

This symposia explores commodity support programs of the U.S. and other developed countries and the benefits and costs of the programs to the countries with support programs and to developing countries, whose agricultural products must compete with subsidized commodities. This is a very timely topic given the current U.S. federal budget situation; U.S. international treaty obligations, which call for the phaseout of subsidies; high agriculturally commodity prices; and the new U.S. government initiative to support agricultural development in developing countries. Speakers will address the following topics:

1. overview of commodity support programs: extent and costs,
2. impacts of commodity support programs on the environment,
3. impacts of commodity support programs on developing countries,
4. impacts of U.S. cotton support programs cotton producers in Mali, and
5. New Zealand's success in ending commodity support programs, and

The symposia will conclude with a 15-min roundtable discussion and question and answer session.

1. Randy Schnepf, Specialist in Agricultural Policy Resources, Science, and Industry Division Congressional Research Service, Washington, DC
 2. David De Gennaro, Legislative and Policy Analyst, Environmental Working Group, Washington, DC
 3. Eric Munoz or Gawain Kripke, Oxfam America, Washington, DC
 4. Daniel Karanja or other Partnership to Cut Hunger and Poverty in Africa representative, Washington, DC
 5. Terry Meikle, First Secretary, Trade and Agriculture, Embassy of New Zealand, Washington, DC
-

#2 Monday, 10:30 a.m. - Congressional B

Anatomy of a Conservation Partnership for Integrated Watershed Restoration

Kristen Saacke Blunk, Penn State Cooperative Extension

ksaackeblunk@psu.edu

The Conewago Creek Collaborative Initiative is one of the three USDA designated "Showcase Watersheds" and was selected because of the high level of coordination and collaboration underway between the community, agencies and organizations that seek to improve local water quality and decrease the loads of nitrogen, phosphorus, and sediment stemming from cumulative land practices.

The Initiative takes a four pronged approach to integrated watershed restoration that focuses on the watersheds assets, resources, and desired outcomes - or more simply - people, practices, place, and impact. Key tools, practices, and approaches underway include a community visioning process that has placed at the Initiative's center the values, goals, and culture of the local residents; a social survey of water quality attitudes and practices that establishes a baseline to which education and outreach is targeted; a conservation district-led farm-to-farm survey of current practices that identifies gaps in practices and priorities; and an environmental monitoring network that partners federal (United States Geological Survey), state (PA Department of Environmental Protection, universities), county (conservation district), and local (watershed organization) partners and their respective water resource assessments to enhance identification of early environmental signals of change.

The Conewago Initiative is being carried forward by four teams, Stewardship Development, BMP Implementation, Monitoring, and Environmental Markets, with a steering group, the Project Advisory Team, comprised of leads for each of the partner organizations. This project has been designed to serve as a "discovery watershed" and will provide guidance for other watershed initiatives confronted by similar legacy pollutants.

1. Matt Royer, Penn State Cooperative Extension, mroyer@psu.edu
2. Mike Hubler, Dauphin County Conservation District, mhubler@dauphinc.org
3. Susan Marquart, NRCS-PA, pa.usda.gov
4. Kathy Brasier, Penn State Cooperative Extension, kbrasier@psu.edu
5. Michael Langland, USGS, langland@usgs.gov

#3 Tuesday, 1:30 p.m. - Congressional A

Assessing Conservation Effects in Wetlands to Estimate Ecosystem Services

William Effland, USDA-NRCS

william.effland@usda.gov

In collaboration with ARS, USGS, academia and other partners, this symposium describes research to develop the USGS/USDA CEAP-Wetlands Integrated Landscape Model (ILM) that allows analysis and assessments of conservation effects while quantifying changes in ecosystem services resulting from changes in land cover and other factors related to wetland conservation practices and programs. The ecosystem services being modeled for wetlands include: pollutant regulation (nutrients - N, P); sedimentation/erosion (RUSLE2, sediment); biodiversity (amphibians, wildlife, vegetation, pollinators); flood storage (water quantity); greenhouse gases (GHG) mitigation (C sequestration, denitrification). Five CEAP Wetlands regional investigations are ongoing: 1-Prairie Pothole Region, 2-Mississippi Alluvial Valley, 3-The High Plains, 4-California Central Valley and the Upper Klamath River Basin, and 5- the Mid-Atlantic Rolling Coastal Plain and Coastal Flats, along with two smaller-scale studies in the Southeast Coastal Plain and Glaciated Interior Plains. Development of the ILM will provide the NRCS with a tool to simulate and forecast changes in ecosystem services provided by wetlands and associated lands as a result of conservation programs and practices, climate change, and other factors that can be built into the model over time. The modeling and monitoring framework will be integrated with the National Resources Inventory (NRI) so that the NRCS can monitor and predict trends in wetland condition/function (ecosystem services) and report regional to national status, condition and trends using the statistical protocols and inference capabilities of the NRI. CEAP Wetlands regional studies provide scientifically-based information documenting the effectiveness of conservation practices and land treatments within the broader regional study framework. These regional studies can be augmented by integration with the NRI and continued collection of field-scale results to improve on-the-ground conservation.

Presentations:

- Ecosystem Services Provided by High Plains Playas: Status and Needs
Loren M. Smith, Oklahoma State University
 - Diverse Applications of Wetland Restoration Practices in the Southeast U.S., and the Implications for Ecosystem Services
Diane DeSteven, USDA Forest Service Southern Research Station
 - The Quantification of Multiple Ecosystem Services for Decision Makers: A Model Demonstration Using Knowledge Derived From CEAP-Wetlands
David Mushet, U.S. Geological Survey, Northern Prairie Wildlife Research Center
 - Assessment of watershed-scale effects of wetland restoration on water quality, Upper Klamath
Sharon Kahara, Wildlife Department, Humboldt State University
 - Forecasting Effects of Conservation Practices on Ecosystem Services in the Mississippi Alluvial Valley
Stephen Faulkner, U.S. Geological Survey
-

#4 Tuesday, 1:30 p.m. & 3:30 p.m. - Palladian

Bioenergy Production: Can Bioenergy Grow Our Energy Independence?

Lyn Kirschner, USDA-NRCS

lyn.kirschner@ftw.usda.gov

This symposium should advance the development of perennial herbaceous biomass-based bioenergy. By discussing the potential for perennial biomass production, and to the many challenges associated with transforming current land uses to those that support biomass production while protecting and enhancing natural resource conservation. The goal of the symposium is to elevate the visibility of important issues and questions, particularly regarding the ecosystem services provided by bioenergy production, looking at policies, production and practicality.

The first theme provides background and context of the opportunities and challenges in the policy realm. Giving an economic portrait of biomass production, and the types of policy that may help promote perennial crop production on agricultural lands. The second session focuses on biomass production, with detailed information about genetics, yields and ecosystem services in biomass production under differing agronomic intensities. Concluding with a panel discussion on potential next steps to pursue, including responses to questions from the audience.

Issues that will be addressed:

Will biomass yields be sufficient to meet feedstock demands with use of existing varieties and cultivars, and basic management practices? If not, would biomass production on marginal lands require cropping and management systems that need a high level of nutrient and pest management? If higher inputs are required, what will be the impacts of petroleum-based inputs to the overall system carbon footprint, lifecycle energy balance, soil quality, and the profitability of marginal lands? Are there enough land acres available to be converted from marginal cropland and pastureland, conservation reserve and non-cropped land, to supply a feedstock market?

The need is to find "bioenergy common ground;" the intersection of ecology, science, policy, economics, and the needs and values of local people.

Opening Session: Policy Implications for Bioenergy Crop Production

- Opening Remarks
Dr. Wayne Honeycutt, Deputy Chief for Science and Technology, USDA-Natural Resources Conservation Service
- Environmental Considerations of the National Renewable Fuel Standard
Paul Argyropoulos, Senior Policy Advisor, EPA Office of Transportation & Air Quality
- Biomass Production Sustainability Standard and Certification Process
John Heissenbuttel, Co-chair Council on Sustainable Biomass Production
- How POET is Making Sustainable Cellulosic Ethanol
James Sturdevant, Director of Project Liberty, POET

Second Session: Bioenergy Cropping Systems (Starts at 3:30 p.m.)

- Biomass; Production, Harvesting, Handling and Storage
Don Tyler, Soil Scientist, University of Tennessee
- Biofuel Crops for the Southeastern U.S.
Brian Baldwin, Professor/Research Agronomist, Mississippi State University

Panel Discussion: Bioenergy Sustainability; Where Are We, and Where We Are Headed?

- Harry Baumes, USDA, Director Office of Energy Policy and New Uses
 - Don Tyler, Soil Scientist, University of Tennessee
 - Brian Baldwin, Professor/Research Agronomist, Mississippi State University
 - James Sturdevant, Director of Project Liberty, POET
-

#5 Monday, 10:30 a.m. - Congressional A

Conservation Treatment Needs for cropland identified by the Conservation Effects Assessment Project (CEAP)

Arnold King, Texas A&M AgriLife Research

arnolddking@hotmail.com

The CEAP National Cropland Assessment was designed to quantify the environmental effects of conservation practices applied to cropland fields of the United States. Preliminary results from the assessment are now available for all regions. The assessment also provides data related to the needs and effects of applying additional conservation practices to the croplands of the United States.

The assessment of conservation practices in use on cultivated cropland for the time period 2003-2006 shows that:

- about half of cropped acres are adequately treated relative to the inherent vulnerability state of the fields,
- about 20 percent are critically under-treated and require additional conservation treatment for excessive losses of sediment, nitrogen, and/or phosphorus from fields, and
- about one-third of cropped acres are less severely under-treated, requiring additional treatment only for nitrogen loss or phosphorus loss.
- Model simulations show that if comprehensive suites of erosion control and nutrient management practices were used on all under-treated acres, field-level losses of sediment and nutrients would be reduced to acceptable levels for almost all cultivated cropland acres. The simulations were designed to add additional practices needed to:
 - avoid or limit the potential for loss by using nutrient management practices (appropriate rate, timing, and method) on all crops in the rotation;
 - control overland flow where needed; and
 - trap materials leaving the field using appropriate edge-of-field mitigation where absent.
- This symposium focuses on an evaluation of conservation practices in use during 2003-2006, how conservation treatment needs were estimated, the geographical distribution of conservation treatment needs, and the potential reduction in field-level losses if the required additional conservation practices were implemented. An open discussion period will follow the presentations.

The symposium will follow this outline:

Moderator: Douglas Lawrence, NRCS, Washington DC

- First Presentation: Jay Atwood, NRCS, Temple, Tx - The Baseline Condition - An evaluation of Conservation Practices in Use during 2003-2006
 - Second Presentation: Robert Kellogg, NRCS, Beltsville, MD - Estimates of Adequately Treated and Under-Treated Cropland in the US.
 - Third Presentation: Lee Norfleet, NRCS, Temple, Tx - Assessment of Potential Gains from Additional Conservation Treatment of Under-Treated Acres
 - Open discussion led by moderator, Douglas Lawrence, NRCS, Washington DC
-

#6 Monday, 1:30 p.m. - Congressional B

HUMUS Findings - A national/regional summary of water quality results

Arnold King, Texas A&M, AgriLife Research
arnolddking@hotmail.com

The CEAP National Cropland Assessment was designed to quantify the environmental effects of conservation practices applied to cropland fields of the United States. The CEAP system consists of :

- APEX to simulate the impact of conservation practices on cultivate lands,
- Geospatial data including soils, topography, land use, ponds and reservoirs, point sources, atmospheric deposition, and weather.
- Detailed land management data on cultivated lands from CEAP surveys.
- Tools for automated calibration and scenario analysis.
- SWAT to simulate non-cultivated lands, channel and reservoir routing, and ultimately the offsite impact of conservation practices.
- This symposium focuses on offsite water quality impacts of conservation practices including sediment, nutrient, and atrazine loads and concentrations for all major rivers of the United States. Lessons learned on data input development and model calibration/validation will be discussed. Model scenario results and sediment and nutrient loadings will be presented for the Mississippi River Basin, Chesapeake Bay, and Great Lakes. Integration of CEAP river basins for the Resource Conservation Act (RCA) appraisal will also be discussed. An open discussion period will follow the presentations.

The symposium will follow this outline:

Moderator: Tom Gerik, Texas AgriLife Research-, Temple, Tx

- First Presentation: Mauro DiLuzio, Texas AgriLife, Temple, Tx - Lessons learned on developing national data sets and development of a geospatial database manager
 - Second Presentation: N. Kannan, Texas AgriLife, Temple, Tx - Calibration and validation results for the Mississippi River Basin, Chesapeake Bay, and Great Lakes
 - Third Presentation: C. Santhi, Texas AgriLife, Temple, Tx - Offsite scenario results for the Mississippi River Basin, Chesapeake Bay, and Great Lakes
 - Fourth Presentation: Jaehak Jeong, Texas AgriLife, Temple, Tx - Integration of CEAP into a national RCA appraisal - results and lessons learned
 - Open discussion led by moderator, Tom Gerik, ARS, Temple, Tx
-

#7 Monday, 1:30 p.m. & 3:30 p.m. - Congressional A

Choptank River Watershed Project: Advancing Science to Improve Conservation and to Reduce Risk

Cathleen Hapeman, Greg McCarty and W. Dean Hively

cathleen.hapeman@ars.usda.gov

The Choptank River Watershed on the eastern shore of the Chesapeake Bay is a USDA-Agricultural Research Service (ARS) Benchmark Watershed consisting of 1,756 km² of land draining into 280 km² of estuarine waters. Land use is dominated by croplands (58%), which support animal feeding operations (primarily chickens with some dairy), followed by 26% forested areas, and 5% small towns. Much of the watershed is extensively ditched. Water quality has declined over the last three decades and portions of the river have been identified as impaired waters under Section 303(d) of the Federal Clean Water Act for nutrients and sediments. In the 2004, ARS partnered with USDA-Natural Resources Conservation Service (NRCS) to spearhead a multi-institution, multi-agency effort to develop methods to measure the effectiveness of conservation practices within the watershed and to identify management practices to improve water quality. The purpose of this symposium is to bring together the key researchers in the Choptank River Watershed to assess the state of the science, to examine the current conservation practices, and to discuss implementation of adaptive management strategies to accelerate restoration efforts in Chesapeake Bay. Presentations will include: nutrient and pesticide fate as affected by landscape features; discerning pollutant sources; the use of remote sensing to identify BMP implementation and to delineate soil wetness; strategies to estimate excess nitrogen; and relating results of the Choptank River watershed to other areas within the Chesapeake Bay watershed.

Presentations:

1. Cathleen Hapeman, USDA-ARS, cathleen.hapeman@ars.usda.gov
Overview of Choptank River Watershed Project
 2. Gabriela Niño de Guzmán, University of Maryland, gabriela.ndg@gmail.com
Cross-comparison of agricultural pollutants in a subwatershed of the Choptank River watershed
 3. Scott Ator, USGS, swator@usgs.gov
Evaluating nitrate concentration trends in the Choptank River
 4. Thomas Jordon, SERC, jordanth@si.edu
Assessing denitrification in agricultural watersheds from stream water N₂ and isotopes in nitrate
 5. Rebecca Fox, University of Maryland, rfox@umces.edu
Temporal and spatial variability of dissolved gases in groundwater of wetland and agricultural areas in the Choptank Basin
 6. Anne Gustafson, University of Maryland, abgust@hpl.umces.edu
The effects of water control structures in agricultural drainage ditches on groundwater levels, nitrate concentrations, and excess N₂.
 7. Clifford Rice, USDA-ARS, clifford.rice@ars.usda.gov
Metolachlor-ESA as a marker for nitrate flux in a first-order stream and riparian zones
 8. Aisha Sexton, USDA-ARS, aisha.sexton@ars.usda.gov
Use of watershed-scale water quality models to examine BMP effectiveness
 9. W. Dean Hively, USGS-Eastern Geographic Science Center, whively@usgs.gov
Adaptive management of winter cover crops through remote sensing and data aggregation
-

#8 Monday, 1:30 p.m. & 3:30 p.m. - Regency

Conservation Practices to Mitigate and Adapt to Climate Change - 12th Annual SWCS-SSSA Joint Symposium

Jorge A Delgado USDA ARS

jorge.delgado@ars.usda.gov

This is the 12th Annual SWCS-SSSA Joint Symposium. It will be held at the July 17-20, 2011 SWCS Annual Meeting in Washington, D.C. and at the October 16-20, 2011 SSSA Annual Meeting in San Antonio, Texas.

This topic, Conservation Practices to Mitigate Climate Change, is of great importance and interest to both societies. Climate change is a topic that is drawing more and more attention from the scientific community, governments, and the general public. The policies that will need to be implemented to address climate change will have to consider the changes to the carbon, nitrogen and hydraulic cycles, how we will adapt to climate change, and how we will implement mitigation practices (which may require site-specific conservation strategies) that will protect ourselves and our limited natural resources. It is important to present the research on how conservation practices could contribute to mitigating the effects of a changing climate, and how to implement strategies to preserve natural resources needed for food security and other uses, especially under extreme climate events that are expected to occur more frequently. These issues are likely to have a significant impact on agricultural policy in the U.S. and internationally in the 21st century.

First Oral Section:

Moderator: Warren J. Busscher, USDA-ARS, Florence, SC

1:30-2:00 pm Conservation Practices and Their Potential to Mitigate Climate Change.

Jerry L. Hatfield, National Laboratory for Agriculture and the Environment, Ames, IA.

2:00-2:30 pm Greenhouse Gas Impacts of Landscape Conservation Practices.

Arthur J. Gold, Dept. of Natural Resources Science, University of Rhode Island, Kingston, RI.

2:30-3:00 pm Farm-level Accounting of Greenhouse Gas (GHG) Emissions: Maximizing Efficiency of Agricultural GHG Mitigation Strategies.

Keith Paustian, Dept. of Soil and Crop Sciences, Colorado State University, Ft. Collins, CO.

Second Oral Section:

Moderator: Warren J. Busscher, USDA-ARS, Florence, SC

3:30-4:00 pm Nitrogen Management for Carbon Credit.

Neville Millar, W.K. Kellogg Biological Station, Michigan State University, Hickory Corners, MI.

4:00-4:30 pm Conservation Practices to Mitigate and Adapt to Climate Change.

Jorge A. Delgado, USDA-ARS, Fort Collins, CO.

Note: This presentation will cover the feature article of the July-August 2011 issue of the Journal of Soil and Water Conservation.

4:30-5:00 pm Policy Opportunities to Mitigate and Adapt to Climate Change.

Eliav Bitan, National Wildlife Federation.

Conservation Practices to Mitigate and Adapt to Climate Change - 12th Annual SWCS-SSSA Joint Symposium

Poster Section - Tuesday, July 19th, 2011:

1. Estimating Soil Organic Carbon Sequestration throughout the Cotton Belt with the Soil Conditioning Index. Alan J. Franzluebbers¹, M. Lee Norfleet², and Michael D. Hubbs³. ¹USDA ARS, Watkinsville, GA; ² USDA NRCS, Temple, TX; ³ USDA NRCS, Washington DC.
2. Potential of the Conservation Reserve Program to Mitigate Climate Change: Implications from Physically Isolated Soil Fractions Across the Great Plains of the US. Catherine Stewart¹, Ronald F. Follett¹, and Elizabeth G. Pruessner¹. ¹USDA-ARS, Fort Collins, CO.
3. A GIS Assessment to Identify and Reduce Nitrate Loads that Contribute to Hypoxia in the Gulf of Mexico. Theodis Bunch¹, Jorge A. Delgado², Cal Shumway³, Leroy Hansen⁴, and Marc Ribaud⁴. ¹USDA-NRCS, NWMC, Little Rock, Arkansas; ²USDA-ARS, Fort Collins, Colorado; ³ASU, Jonesboro, Arkansas; ⁴USDA-ERS, Washington, D.C.
4. The Adapt-N Tool Facilitates Both Adaptation and Mitigation of Climate Change. Harold van Es¹, Jeff Melkonian¹, and Bianca Moebius-Clune¹. ¹Department of Crop and Soil Sciences, Cornell University.
5. Nutrient Tracking Tool – APEX (NTT-APEX). Christoph M. Gross¹, Shaun P. McKinney², Harbans Lal², Eric Hesketh³, and Joseph Bagdon³. ¹ USDA-NRCS, Beltsville, MD; ²USDA-NRCS, Portland, OR, ³ USDA-NRCS, Amherst, MA.
6. Precision Manure Management Conservation Practices: Surface Soil Quality and Environmental Impact. R. Khosla¹, M.E. Moshia¹, J.A. Delgado², and L. Longchamps¹. ¹Colorado State University, Fort Collins, CO; ²USDA-ARS, Fort Collins, CO.

#9 Monday, 3:30 p.m. - Empire

Environmental Outcomes of Conservation Practices applied to Grazing Lands

Mark Weltz, ARS

mark.weltz@ars.usda.gov

For more than 20 years, NRCS has assessed the expected physical effects of conservation systems and practices in the context of ecological, economic, and social considerations. This has been done in a very qualitative fashion and is known as the Conservation Practice Physical Effects matrix (CPPE). The symposium will present how new understandings in science from synthesis of published literature can be integrated with professional knowledge and expertise acquired in the field to better inform conservation. The symposium will review current conditions of non-federal rangelands across the 17 western states using data derived from the NRCS National Resource Inventory and new quantitative methods for assessing the benefits of conservation on rangelands and pasture lands. The symposium will discuss our current knowledge about the distribution of soil erosion and invasive species on non-federal rangelands and how new metrics to measure the sustainability of rangelands maybe more efficient than using average annual soil loss. The speakers will describe USDA's current capacity to estimate conservation benefits at the watershed scale and how we can evaluate net cumulative benefits of layered conservation practices to assess ecosystem services provided by grazing land landscapes. In conclusion the speakers will identify gaps in our knowledge of how to quantify benefits from rangeland and pasture land conservation practices and areas that need additional research if we are to quantify benefits and ecosystem services from conservation practices at hillslope, watershed, and river basin scales.

Moderator: Doug Lawrence, Deputy Chief, NRCS, Washington, DC

- Leonard Jolley, NRCS, Beltsville, MD - The scope and current capabilities in estimating benefits from conservation on rangelands.
- David Briske, Texas A&M, College Station, TX - Rangeland CEAP Literature Synthesis Documenting Benefits of Conservation.
- C. Jerry Nelson, Univ. of Missouri, Columbia, MO- Pasture Land CEAP Literature Synthesis Documenting Benefits of Conservation.
- Mark Weltz, ARS, Reno, NV- National assessment of soil loss using National Resource Inventory data for rangelands.
- Ken Spaeth, NRCS, Ft. Worth, TX- National assessment of rangeland health using National Resource Inventory data for rangelands.
- Phil Guertin, University of Arizona, Tucson, AZ - Estimating benefits of conservation practices at the watershed scale on rangelands

#10 Monday, 10:30 a.m. - Empire

EPA Programs and Implementation Collaboration Now and in the Future

Katie Flahive, US Environmental Protection Agency

flahive.katie@epa.gov

The Clean Water Act provides a number of voluntary and non-regulatory tools that can assist watershed managers in agricultural areas with planning, implementation and water quality monitoring. EPA provides guidance and assistance to states for implementation of a host of programs and authorities (106, 303d, 319, 604b, etc.) that assist states with their federal partners (USGS, USDA), local government and NGOs in implementing watershed work.

The symposium will provide an overview of these programs and present recent developments in how all partners (federal, state, local and NGO) can coordinate to best maximize effectiveness in watershed planning, conservation practice implementation and water quality tracking and monitoring at multiple scales. For the first half of the 90 minute symposium, the national EPA program managers will be joined by other federal agency partners to describe the different and complementary aspects of specific programs. For the second half of the 90 minute symposium, two examples of how the coordinated effort to implement available federal state, local and NGO programs allows local landowners to reap the benefits by showing water quality improvements.

This should be the first in series of two symposia, to be followed by the symposium titled, "Using Nonpoint Source Stories to Communicate Water Quality Successes."

1. Dov Weitman, Nonpoint Source, EPA Office of Water, weitman.dov@epa.gov
2. Program Manager, Listing and Assessments, EPA Office of Water
3. Program Manager, Clean Water State Revolving Fund, EPA Office of Water
4. Two Watershed Collaborators, MARB and Chesapeake Bay

#11 Tuesday, 3:30 p.m. - Regency

Evaluations of the current state of agricultural nitrogen use and cost-effective means of reducing environmental impacts

LeRoy Hansen, USDA-ERS

lhansen@ers.usda.gov

This symposium examines the agricultural use of commercial nitrogen fertilizers and manure. The overall objective of the analyses to be presented in this symposium is to evaluate the cost-effectiveness of economic incentives to adopt on- and off-field nitrogen conservation practices. The participating researchers examine the current status of nitrogen use by crop across the United States, evaluate the effect of nitrogen prices on farmers' production and nitrogen application decisions, evaluate the incentive that the creation and sale of nitrous oxide offsets might provide for improved nitrogen management, quantify (using the Nitrogen Loss and Environmental Assessment Package) nitrogen losses and changes in losses given current and expanded use of field-level nitrogen conservation practices, and estimate and compare the cost of reducing nitrogen loadings by establishing vegetative filters and restoring wetlands. Together, the papers presented in this symposium provide national and regional perspectives on agricultural nitrogen use and losses and the cost of alternative nitrogen conservation practices.

1. Mike Livingston, USDA, Econ. Res. Service, mlivingston@ers.usda.gov
A cross-sectional assessment of the use of nitrogen conserving practices and potential for further expansion
 2. Jim Williamson, USDA, Econ. Res. Service, jwilliamson@ers.usda.gov
The effects of price and market-related information on farmers' nitrogen-use decisions
 3. Marc Ribaud, USDA, Econ. Res. Service, mmribaud@ers.usda.gov
Preliminary assessment of payments for nitrous oxide reductions from corn production
 4. Jorge Delgado, USDA, ARS, jorge.Delgado@ars.usda.gov
Potential Use of Nitrogen Management to Reduce Nitrogen Losses Across Different US Agro-Ecosystems
 5. LeRoy Hansen, USDA, Econ. Res. Service, lhansen@ers.usda.gov
Costs of reducing nitrogen loading through wetland restoration and establishment of vegetative filter strips
-

#12 Monday, 3:30 p.m. - Congressional B

Fish and Wildlife Conservation: Emerging Findings from the CEAP Wildlife Component

Charles Rewa, USDA NRCS

charles.rewa@wdc.usda.gov

Conservation programs funded through federal farm legislation have produced substantial fish and wildlife habitats in the United States. The Conservation Effects Assessment Project (CEAP) is a multi-agency effort examining the environmental benefits of conservation practices applied through these programs. The CEAP Wildlife Component is documenting biodiversity-related ecosystem services provided by USDA conservation efforts. The effort involves a variety of assessment projects, most of which are applied at regional landscape scales through partnerships between the Natural Resources Conservation Service and elements of the fish and wildlife science and management communities. Building on findings presented at previous SWCS conferences, this symposium presents an update on the CEAP Wildlife Component and some of the results being generated, with an emphasis on how the information can be used to improve management of working agricultural lands for the benefit of fish and wildlife resources.

Presentations:

- Assessing NRCS Conservation Practice Effectiveness Using Stream Fishes
Jeffrey D. Fore, Department of Fisheries and Wildlife Sciences, University of Missouri, Columbia
 - Assessing benefits of conservation practices to the biological integrity of agricultural streams in Michigan and Wisconsin
Scott P. Sowa, The Nature Conservancy
 - Running conservation like a business: Linking science and management to benefit populations
David Naugle, Wildlife Biology Program, University of Montana, & USDA Science Advisor for NRCS Sage Grouse Initiative
 - Science and Conservation Combating the Gulf Oil Spill: The Migratory Bird Habitat Initiative
Richard M. Kaminski, Mississippi State University
 - Wintering waterfowl and migrating bird response to WRP in California
Jeffrey Buler, Department of Entomology and Wildlife Ecology, University of Delaware, Newark, Delaware
 - Contribution of WRP to the energetic needs of migrating waterfowl in southern Oregon and northern California
Daniel Casey, American Bird Conservancy
 - Short- and long-term effects of haying on breeding birds in CRP grasslands in the Northern Great Plains
Douglas H. Johnson, U.S. Geological Survey, Northern Prairie Wildlife Research Center
 - Northern Bobwhite Response to Conservation Reserve Program Habitat and Landscape Attributes in Maryland and Delaware
Peter J. Blank, University of Maryland
-

#13 Tuesday, 3:30 p.m. - Empire

Implementing adaptive management and valuing ecosystem services in national water resource policy and law

Steve Young, University of Nebraska-Lincoln

syoung4@unl.edu

Currently, US national water policy is fragmented and incomplete, creating difficulty for policy makers and regulators. As an ecosystem resource, water resources are largely unregulated and unaccounted for. Adaptive management offers a flexible and improved approach to water resource management. The range in definitions for adaptive management have been narrowed by different agencies in the federal government, but its implementation has been difficult due to rigid policy guidelines that fail to account for dynamic biological systems, including water and water dependent services provided by managed ecosystems. A better understanding is needed of how applications have been made to agricultural and natural areas in the past and what is currently being planned for short- and long-term solutions.

In this symposium, 4 national speakers have been invited from state institutions and federal agencies and will make presentations on 1) the state of scientific literature and government policy with definitions, descriptions, methodologies, and identification of challenges for conducting adaptive management for water resources; 2) the current definitions and descriptions of adaptive management from both the policy side and the practical application side (i.e., biological sciences); 3) an approach for merging policy and practice in order to develop methodology that encompasses the regulatory and the applied science of adaptive management; 4) potential alternatives within an adaptive management framework to address the challenges with the national water policy. This symposium brings together policy makers and specialists from state and federal agencies to inform conference participants on the issues, conditions, and potential alternatives to deal with the challenges facing the Nation's water resources.

Speakers:

- Dr. Alan Tomkins, University of Nebraska-Lincoln, Director of the Public Policy Center
 - Dr. Craig Allen, University of Nebraska-Lincoln, Leader of the Nebraska Cooperative Fish and Wildlife Research Unit
 - Jim Dobrowolski, NIFA National Program Leader, Rangeland and Grassland Ecosystems, Agriculture Water Security
 - Eric Biber, University of California
 - Anne Castle - Assistant Secretary for Water and Science, U.S. Department of the Interior (Invited)
-

#14 Tuesday, 1:30 p.m. & 3:30 p.m. - Executive

Innovation in Conservation Policy and Practice: The Case of the Conservation Stewardship Program

Greg Fogel, National Sustainable Agriculture Coalition (NSAC)

gfogel@sustainableagriculture.net

The Conservation Stewardship Program (CSP) is a comprehensive working lands conservation program that provides technical and financial assistance to farmers and ranchers to actively manage and maintain existing conservation systems and to implement additional conservation activities on land in agricultural production. This symposium will highlight the CSP as an innovative model for protecting natural resources and the environment while maintaining farm and ranch land productivity. The CSP uses a uniquely comprehensive tool-known as the Conservation Measurement Tool (CMT)-to determine conservation performance for existing and additional conservation activities for potential contracts. This information is then used to determine eligibility, ranking, and payment levels. In addition to the CMT, the program is differentiated by its dual reward structure for managing existing and implementing new conservation practices and activities, the focus on a comprehensive conservation approach keyed into state or watershed-based priority concerns, an emphasis on continual improvement, and the higher resource and environmental standards required relative to other federal working lands conservation programs. Currently, over 25 million acres are enrolled in the CSP, and by the summer of 2011 it will reach 38 million acres. This symposium will summarize CSP history, detail CSP components, discuss how it is working on the ground, and explore future options for the program.

Overview Presentations:

- Ferd Hoefner, NSAC - Overview, Background and Status of the CSP
- Phil McCloud, NRCS - The CSP Conservation Measurement Tool

Case Study Presentations:

- Tom Nuessmeier, Farmer, CSP Participant, Minnesota
- Jim Thorpe, Rancher, CSP Participant, New Mexico
- Brad Redlin, Izaak Walton League of America - CSP and Wildlife Considerations
- Ferd Hoefner, NSAC - Where the Program Goes From Here - 2012 Farm Bill and Beyond

General discussion, question and answer session.

#15 Tuesday, 1:30 p.m. & 3:30 p.m. - Congressional B

Managed Grazing: The Forgotten Hero of Conservation

Laura Paine, WI Department of Agriculture, Trade, & Consumer Protection

laura.paine@wi.gov

Well-managed pasture is an under-appreciated conservation tool in the humid Eastern United States. Significant policy and educational barriers stand in the way of increasing its use. Combining perennial vegetation cover, reduced pesticide and fertilizer inputs, and lower cost of production, managed grazing is a system that can generate ecosystem services for society as well as economic sustainability for the producer.

The majority of currently available policy tools were designed to address rangeland grazing situations in the west and conservation cropping in the east. To promote well-managed pastures in eastern humid areas, resource managers and agency staff struggle to adapt programs that are really designed for annual row crop systems. Additional educational and technical assistance resources are needed as well.

This symposium will summarize the potential of well-managed grazing to provide ecosystem services, provide a forum for discussion of the barriers to adoption of managed grazing in the eastern United States and offer some solutions to move managed grazing forward through policy and educational efforts.

Presenters and topics:

1. Environmental performance and potential ecosystem services of well-managed pasture
Alan Franzluebbers, Ecologist, USDA - Agricultural Research Service, Watkinsville GA
 2. Barriers to the adoption of management-intensive grazing in the humid eastern region of the U.S.
Jonathan Winsten, Winrock International
 3. The Grazing Lands Conservation Initiative and federal agriculture policies that promote well-managed grazing
Kevin Ogles, Grazing Lands Specialist, USDA – Natural Resources Conservation Service, Greensboro NC
 4. The Wisconsin GLCI Grant Program: How we use the GLCI to promote grazing in Wisconsin
Laura Paine, WI Department of Agriculture, Trade, and Consumer Protection
 5. A Policy 'wish-list' for grazing
George Boody, Land Stewardship Project.
 6. Farmer Panel and general discussion
-

#16 Tuesday, 10:30 a.m. - Executive

The National Climate Assessment - Science, Processes, and Products

Emily Cloyd, US Global Change Research Program

ecloyd@usgcrp.gov

The National Climate Assessment (NCA), under the auspices of the US Global Change Research Program, synthesizes scientific observations made across the country, evaluates observations in relation to predictions from climate system models, and assesses the state of the current and future climate. In its next quadrennial report, due in 2013, the NCA will integrate scientific information from multiple sources and highlight key findings and significant gaps in our knowledge.

The work of the NCA demonstrates how the federal government can engage effectively with partners at all levels of government, in universities, in the private sector, and with NGOs and professional societies such as the Soil and Water Conservation Society. At this symposium, NCA staff and scientific author teams will provide the audience with a brief overview of the NCA and will facilitate a discussion about the science and processes underlying the production of NCA reports. The audience at SWCS, scientists at all stages in their careers, will be essential to building the strong scientific networks that are needed for the NCA, and their input will be valuable to the continuing development of the NCA process and products.

The majority of the session will be devoted to a discussion about the NCA. Topics for the discussion include designing an assessment that is responsive to the needs of resource managers and decision makers, assessing the quality and breadth of science included in the NCA report, developing a sustained and ongoing assessment process, and addressing other questions and topics raised by members of the audience.

#17 Monday, 10:30 a.m. - Executive

Cooperative Conservation Partnership Initiative Projects

Jimmy Daukas

jdaukas@farmland.org

Agricultural pollution persists at problematic levels, yet conservation budgets face mounting pressure. Improving or increasing the effectiveness of conservation programs could help increase environmental benefits without raising costs. Successful programs will benefit both the environment and agriculture, as they reduce agriculture pollution, improve sustainability, and decrease pressure for regulating farmers and ranchers.

CCPI is one of the most promising programs coming out of the 2008 Farm Bill. It changes the way conservation occurs on the ground. It is collaborative based as opposed to more a la carte conservation programs on an individual farmer basis.

In addition, the whole MRBI initiative represents a pilot approach by NRCS to shift from implementation-driven conservation to a targeted approach and results-based monitoring. The monitoring component of MRBI provides an opportunity to gain understanding of the effect of conservation practices on local water resources and effectiveness of volunteer-driven conservation; however, a new process and monitoring protocols are needed for successful implementation.

Presenters will provide brief overviews of their MRBI CCPI projects and then delve into whether and how the program and their projects are addressing the following key issues:

- Improving the effectiveness of conservation programs;
- Stretching conservation program dollars under a tight budget;
- Reaching farmers and ranchers who need the most help;
- Addressing “critically under-treated acres” identified in the CAP reports;
- Improving monitoring and evaluation;
- Helping to avoid EPA regulation and improve the public’s image of agriculture by solving water quality problems voluntarily.

Attendees will get a better understanding of how projects are working on the ground—what’s working and what are obstacles to success.

Presenters:

1. Anita Zurbrugg, American Farmland Trust, azurbrugg@niu.edu
Engaging Farmers in Improving Water Quality in the Upper Salt Fork River, Illinois
2. Dennis Fuchs, Stearns County Soil Water Conservation District, dennis.fuchs@mn.nacdnet.net
Experiences from Sauk River Watershed Project
3. Eileen Bader, The Nature Conservancy, ebader@tnc.org
The Mississippi River Basin Initiative in the Boone River Watershed, Iowa: Lessons learned from Year One implementation and Monitoring

#18 Monday, 1:30 p.m. & 3:30 p.m. - Palladian

Pollinators and Pollination Services: Technology Development, Policy, and Action

Cheryl Simmons, USDA-NRCS

cheryl.simmons@ftw.usda.gov

As has become more obvious from a number of fairly recent discoveries and situations such as the “success” of invasive weeds in displacing native vegetation, the occurrence of what-we-have-labeled “Colony Collapse Disorder” in honeybees, the spread of white-nosed syndrome among bats, the “development” of formerly more environmentally diverse areas, and the present and projected increased need for animal pollination services to provide healthy food for the increasing global human population, conserving the biodiversity of pollinator species and the habitats upon which they depend is a critical issue. Conducting the necessary research to understand the science of pollination and pollinator habitat needs, developing the technological tools, providing the necessary training, drafting appropriate policy, and implementing the policies to maintain and conserve pollinator populations and their habitats presently require, and will continue to require, more cooperation and collaboration among many diverse partners. We must discover, communicate, and better-utilize our knowledge about pollinators and their required habitats using information from local, regional, national, and international studies in order to identify and implement the management actions necessary to conserve and to sustain pollinators and the pollination services they provide. This symposium will convey on-going pollinator research and technology development, training and outreach, and policy and actions among nine U.S. Federal agencies and two non-governmental organizations to address the needs of pollinators and to sustain animal pollination services.

Overview of Session and Speakers

Dr. Jodi Johnson, Pollinator Partnership Associate - Moderator

Pollinator Policies, Programs, and Actions

1. Jodi Johnson, Ph.D. candidate, Associate with Pollinator Partnership
The Pollinator Partnership and the North American Pollinator Protection Campaign: Collaborative Stakeholder-Driven Approaches to Policy, Research and Conservation for Plant-Pollinator Interactions across North America
2. Tamberly Conway, USDA-Forest Service

Pollinator Enforcement

3. Colin Stewart, USDA-Animal and Plant Health Inspection Service

Pollinator Research

4. Wayne Esaias, National Aeronautical and Space Administration
Mapping Honey Bee Nectar Flow Trends for the Eastern US Reveals Climate Change Impacts
 5. “Chip” Euliss, DOI-United States Geological Survey
Estimating Landscape Suitability for Pollinators: An Integrated and Interdisciplinary Approach
 6. Jeff Peters, Syngenta Crop Protection
Operation Pollinator: Positive Action for Pollinators
-

#19 Tuesday, 10:30 a.m. - Congressional B

Producer Perspectives on Conservation

Gretchen Kamps, Pioneer Farm

kampsg@uwplatt.edu

Do you ever wonder why some farmers participate in programs and actively engage in conversations with you while others kick the gravel until you leave? Join Wisconsin producers involved in on farm research for this symposium to learn more about what motivates them to participate in conservation programs and practices, what their personal responsibility to agricultural sustainability is, and how they feel their farms affect the environment.

They will also discuss:

- What it takes for growers to apply conservation without payments.
- What the critical factors are for achieving local conservation results while maintaining agricultural production and profitability.
- How conservation and production can be blended.

Each producer brings a different perspective based on the type of farming operation they have, the conservation practices they use, and the experiences, both positive and negative that they have had with conservation professionals. Moderated by Dennis Busch, Research Manager of UW-Platteville Pioneer Farm, this will be a great opportunity to hear what motivates producers and give you some tools to help build lasting relationships with producers to get and keep conservation in place. Having this information will assist you in building relationships with farmers in the future as well as give you a different perspective when it comes to regulations and producer acceptance of them.

1. Joe Bragger, WI Soybean Association, UW Discovery Farms
2. Mark Riechers, WI Beef Association, UW Discovery Farms
3. Leon Wolfe, UW-Platteville Pioneer Farm

#20 Tuesday, 1:30 p.m. - Regency

Expanding Conservation Compliance: Options, Opportunities, and Challenges

Michelle Perez, World Resources Institute

mperez@wri.org

Agricultural activities remain a major source of water pollution in the United States. Conservation compliance is the federal quasi-regulatory policy requiring farmers who operate Highly Erodible Land (HEL) to control soil erosion to remain eligible for receiving commodity and conservation program payments. Compliance is credited with achieving 300,000 tons of annual cropland erosion reduction from 1982 and 1997.

Yet, almost as much “unsustainable” soil erosion is occurring on non-HEL land as is occurring on HEL land. And though agriculture is one of the largest sources of nutrient pollution, compliance does not require practices that avoid, control, and trap fertilizer and manure pollution. Despite the federally-subsidized crop insurance program providing more taxpayer dollars to farmers than the commodity programs, it has no environmental eligibility standards.

Given the current budget crisis, policy makers could explore a variety of options for expanding conservation compliance to achieve greater conservation benefits for continued tax payer support. Options include expanding the coverage of compliance requirements to a broader set of environmental issues and expanding the types of government support that are contingent upon an acceptable level of environmental performance. Speakers will explore the potential costs and benefits of expanding compliance, the likely economic, cultural and educational challenges to implementing an expanded program, and the current status of farmer adoption of nutrient-related practices.

Speakers will prepare new analysis for this session by highlighting key findings from their own work, conducting new analysis, presenting findings from colleagues, and scanning the literature for new analyses. With this session, we hope to begin a discussion of how to realize additional conservation benefits within the quid pro quo system of conservation compliance.

Speakers:

1. Dr. Roger Claassen, USDA Economic Research Service, claassen@ers.usda.gov
2. Dr. Michelle Perez, World Resources Institute, mperez@wri.org
3. Marc Ribaud, USDA Economic Research Service, mribaud@ers.usda.gov
4. Dr. Tracy Blackmer, On-Farm Network, tblackmer@iasoybeans.com

Moderator:

Dr. Doug Parker, University of Maryland, dparker@arec.umd.edu

#21 Tuesday, 10:30 a.m. - Forum

Selecting Area-wide and Site-Specific Conservation Activities: Some Policy and Economic Considerations on their Cost Effectiveness

Felix Spinelli, USDA, NRCS
spinelli.felix@gmail.com

This symposium consists of four presentations: two papers that explore how “macro” policy objectives across and within USDA programs could affect successful US conservation program formulation and implementation and two papers that explore “micro” economic aspects of conservation practice adoption.

The first two papers address two over-riding influences originating from external pressures that affect conservation cost-effectiveness: first, the aim to attain regional equity in NRCS conservation programs and the second, the changing landscape that conservation programs work in as it is influenced by other USDA programs. The third and fourth presentations address two over-riding influences originating from internal pressures that affect conservation cost-effectiveness: first, the desire to streamline the cost-share type payments for conservation programs, such as EQIP, and second, and the increased interest to incorporate an increased role for bidding to determine conservation program participation and payment levels.

Presenters:

1. Cindy Nickerson, Economist with the USDA-ERS
2. Dr. Mike Dicks, Professor, Oklahoma State University
3. Kalven Trice and James Rowe, USDA-NRCS
4. Felix Spinelli, USDA-NRCS

#22 Tuesday, 10:30 a.m. - Palladian

Soil and Water Touch Points for Sustainability Standards

Michelle Wander, University of Illinois
mwander@illinois.edu

The symposia will consider how emerging food system sustainability metrics used (food miles, # farms per state, health and nutrition, equity, obesity, global warming impacts) relate to provisioning services: land stewardship, soil and water conservation, erosion and flood prevention, system resilience and maintenance of biodiversity.

The science of sustainability is a hybrid beast spawned by policy legal, technical, and social information. Presenters and discussants will present a range of views. Emerging metrics in the food systems arena are introducing new criteria for valuation that must be combined with principles derived from agroecology, soil and water conservation policy, business standards, and global warming impacts. The 90 minute session will include short statements and a panel discussion that will consider the relative abilities of national, business, and consumer based standards to protect soil, water and wildlife.

1. Michelle Wander, University of Illinois, mwander@illinois.edu
 2. Andrew Manale, EPA, Manale.Andrew@epamail.epa.gov
 3. Nancy Creamer, NC State, nancy_creamer@ncsu.edu
 4. Louise Jackson, UC Davis, lejackson@ucdavis.edu
 5. Jody Endres, University of Illinois, jendres2@illinois.edu
 6. Susan Andrews, NRCS, susan.andrews@gnb.usda.gov
 7. Jonathan Kaplan, NRDC, jkaplan@nrdc.org
-

#23 Monday, 1:30 p.m. & 3:30 p.m. - Executive

Targeting Phosphorus Reduction in Small-Scale Agricultural Watersheds: Lessons from Wisconsin

Pete Nowak, University of Wisconsin-Madison

pnowak@wisc.edu

This symposium will highlight some of the recent and on-going efforts in Wisconsin to target Phosphorus (P) reduction in small-scale agricultural watersheds. There are at least three features of this recent work that are unique, innovative, and therefore appropriate for the theme of this year's SWCS conference. First, tools are being developed and tested as a targeting tool for site-specific, critical sites within agricultural watersheds. These tools (Phosphorus Index and SNAP-Plus model) can also be used to evaluate the impact of remedial practices in achieving watershed P loss reductions to meet water quality goal. Second, research is underway to understand how the modeling tools used by watershed scientists and watershed managers relate to field-level sediment and phosphorus (P) loss assessment tools such as those used by land users and local conservation staff. Third, we know a small proportion of inappropriate behaviors in vulnerable places or times can determine the pollutant loads in an agricultural watershed. Innovative methods are being used to gain farmer involvement in addressing these disproportionate contributions. The proposed symposium will be a combination of formal presentations and a panel session involving farmers to communicate the range of lessons being learned. The program and policy implications of these efforts will be emphasized in accord with the conference themes.

- Pete Nowak, University of Wisconsin-Madison
- John Panuska, University of Wisconsin-Madison
- Laura Ward Good, University of Wisconsin-Madison
- Kevin Kirsch, Wisconsin Department of Natural Resources
- Faith Fitzpatrick, USGS Wisconsin Water Science Center
- Rebecca Carvin, USGS Wisconsin Water Science Center
- Dennis Frame, Discovery Farms, University of Wisconsin Extension
- Amber Radatz, Discovery Farms, University of Wisconsin Extension
- Karl Klessig, Manitowoc County, dairy producer
- Joe Bragger, Buffalo County, dairy, beef, poultry producer
- Mark Riechers, Lafayette County, beef, and grain producer
- Steve Richter, The Nature Conservancy
- Fred Madison, University of Wisconsin-Madison

#24 Monday, 10:30 a.m. - Regency

The Farm Bill and Climate Change

Eliav Bitan, National Wildlife Federation

bitane@nwf.org

The Farm Bill and Climate Change will explore the benefits that the Farm Bill provides for climate change adaptation and mitigation, and ways to improve the 2012 Farm Bill for climate adaptation and mitigation. Speakers will include:

- Bill Hohenstein, USDA
- Former NRCS Chief Bruce Knight
- Laura Sands, Clark Group
- Stephanie Page, Oregon Department of Agriculture
- Julia Olmstead, Institute for Agriculture and Trade Policy

We will review current policy tools, political realities and market opportunities, hear some exciting case studies at a farm scale, and explore policy opportunities for the future.

#25 Tuesday, 3:30 p.m. - Cabinet

Transborder Water Resources Management

Jim Bruce and Melinda McClanahan, SWCS International Committee
melindamcclanahan@gmail.com

The symposia will address transborder water resources and watershed management issues along the USA-Mexico and USA-Canada borders. Presentations will focus on cross-border rangeland management, the use of integrated watershed management in Mexico, the proposed creation of a Canada-USA-Mexico integrated water management program, Canada-USA transborder water management issues, and the Canada-USA Great Lakes Program.

Presenters:

- Ted Yuzyk, Acting Secretary, International Joint Commission, Canadian Section, yuzykt@ottawa.ijc.org
- Phil Heilman, Southwest Watershed Research Center, USDA-ARS, Phil.Heilman@ARS.USDA.GOV
- Ignacio Sanchez-Cohen, National Center for Water, Soil, Plant and Atmospheric Research, Mexico, sanchez.ignacio@inifap.gob.mx
- Lana Pollack, Chair, International Joint Commission USA-Canada, pollackl@washington.ijc.org

#26 Monday, 1:30 p.m. - Empire

Using Nonpoint Source Stories to Communicate Water Quality Successes

Rebecca Roose, US EPA
roose.rebecca@epa.gov

Nonpoint source pollution is the leading remaining cause of surface water pollution. Since 1994 2005 EPA has been working with states to identify section 319 “Nonpoint Source Success Stories” based on specific criteria. These stories highlight waterbodies identified by states as being primarily nonpoint source-impaired and having achieved documented water quality improvements. Success stories also describe innovative strategies used to reduce NPS pollution, the growth of partnerships and a diversity of funding sources. EPA’s efforts to regularly make collections of success stories publicly available serve two main purposes: (1) highlighting states’ restoration efforts; and (2) allowing EPA to track the number of nonpoint source-impaired water bodies that are partially or fully restored.

The symposium will provide an overview of the 319 Nonpoint Source Success Stories framework, including criteria for selecting stories, important considerations for project design, and the process for distribution of success stories. A representative sample of success stories will be highlighted, showing the diversity of approaches that lead to water quality improvements through nonpoint source pollution control. The panel will include a presentation about how partnerships between water quality agencies (e.g., DNR or DEM) and conservation districts strengthen nonpoint source programs and lead to success stories.

The second half of the symposium will involve audience participation through a group activity that will illustrate several key challenges to achieving and documenting successes. Groups will draft a success story for an impaired stream scenario and then report to the large group observations, lessons learned and ideas for application to other programs.

1:30-2:05 Panel Presentations

1:30-1:45 Fred Suffian – Introduction to EPA Program Measures for the Nonpoint Source Program

1:45-1:55 Shanon Phillips – Managing a State Nonpoint Source Program for Successes

1:55-2:05 Clay Pope – Interagency Cooperation to Address Water Quality Impairments Associated with Agricultural Practices

2:05-2:15 Q&A

2:15-2:50 Group Activity

2:50-3:00 Large Group Discussion

#27 Tuesday, 10:30 a.m. - Congressional A

Verification and Continuous Improvement of Conservation Performance for Water Quality Protection

Tom Simpson, Water Stewardship, Inc

toms@waterstewardshipinc.org

The need for agriculture to provide greater accountability and evidence of progress in conservation implementation is increasing rapidly, particularly related to water quality and Total Maximum Daily Loads (TMDLs). NRCS and Conservation Districts are the implementers, so questions arise about them serving as independent implementation verifiers and staff limitations restrict time available for such efforts. Further, Farm Bill programs have focused efforts on specific programs and practices rather than whole farm planning to achieve specific resource protection, e.g. water quality.

A private, nonprofit third party program was developed and tested in Virginia's Shenandoah Valley to verify current implementation and identify additional opportunities to reduce farm water quality impacts. A Continuous Improvement Program (CIP) was developed for each farm with the long term goal of achieving local and Chesapeake Bay water quality goals. The CIPs are implemented in two year cycles based on farmer readiness, practice impact and economic considerations. Each CIP cycle achieves at least one-sixth of needed reductions. Progress is verified biennially and the farmer agrees to implement additional practices during the next cycle. Over a maximum of six CIP cycles or 12 years, the farmer will achieve needed reductions. Farmers are sent to NRCS and Conservation Districts for technical and financial assistance.

This approach has brought new farmers into conservation programs and resulted in additional implementation by current cooperators. It is complimentary to NRCS and District work and allows farmers to focus on practices that move them efficiently towards water quality goals. The program has been well received by farmers and has integrated well with conservation agency programs. It is proposed that independent, third party assessment and continuous improvement programs with government oversight should meet the "reasonable assurance" requirements for TMDLs.

1. 1) Tom Simpson, Water Stewardship toms@waterstewardshipinc.org
2. 2) Cory Gulliams, USDA-NRCS, Cory.Guilliams@va.usda.gov *
3. 3) Anthony Beery, Farmer
4. 4) Dan Kaiser, Water Stewardship, dank@waterstewardshipinc.org

#28 Tuesday, 3:30 p.m. - Congressional A

An Overview of the Mid-Atlantic Regional Wetland Conservation Effects Assessment Project

Megan Lang, USDA-FS

mwlang@fs.fed.us

Wetlands provide many important ecosystem services, including the maintenance of water quality, the stabilization of the climate through carbon sequestration, and enhancement of biodiversity through the provision of food and habitat. The conversion of natural lands to agriculture has led to large scale wetland loss, but current USDA conservation programs and practices seek to replace or ameliorate the ecosystem services lost to agricultural conversion. The Mid-Atlantic Regional Wetland (MIAR) Conservation Effects Assessment Project (CEAP) is a regional element of the national CEAP Wetlands component study which was initiated by the Natural Resources Conservation Service (NRCS) to assess ecosystem service restoration. The MIAR is an interdisciplinary study which brings together scientists from multiple federal agencies (NRCS, Agricultural Research Service, U.S. Geological Survey, and Smithsonian Environmental Research Center) and the University of Maryland to study non-tidal wetlands in the Mid Atlantic Coastal Plain. An overview of this multifaceted project will be given.

Presentations:

- Denitrification and nitrous oxide emissions in the Mid-Atlantic Coastal Plain
Patrick Hunt, USDA-ARS
- The Importance of Groundwater Flow Patterns to the Effectiveness of Wetlands at Mitigating Agricultural Nitrogen Transport to Local Streams
Scott W. Ator, US Geological Survey
- Remote Monitoring of Wetland Function across a Landscape Alteration Gradient
Megan Lang, USDA Forest Service Northern Research Station, mwlang@fs.fed.us
- Trends in Soil Phosphorus in Native, Disturbed and Hydrologically Restored Agricultural Wetlands
Clinton D. Church, USDA-ARS, University Park, PA
- Soil Carbon and Recent Soil Erosion in Depressional Wetlands Under Different Managements in the Mid-Atlantic Coastal Plain
Daniel Fenstermacher, University of Maryland

Special Poster Symposia Session Tuesday, 10:30 a.m. - Regency

Utilizing the 4R Nutrient Stewardship Framework

Lara Moody, The Fertilizer Institute

lmoody@tfi.org

The goal of this symposium is to educate participants about 4R nutrient stewardship and its benefits, to present them with successful applications of 4R use in the field, and to provide them with access to 4R implementation tools.

- Poster 1: The Right Time for Nutrient Stewardship is Right Now
Lara Moody, Director of Stewardship Programs, The Fertilizer Institute
- Poster 2: Implementing 4R Nutrient Stewardship on the Farm
Steve Phillips Director, Southeast United States, International Plant Nutrition Institute
- Poster 3: Utilizing GIS Data Management to Implement 4R Practices
Quentin Rund, Senior Consultant, PAQ Interactive
- Poster 4: Spatial Variability of the Right Rate and How it Effects Timing and Placement
Josh McGrath, Assistant Professor, Dept. of Environmental Science & Technology, University of Maryland
- Poster 5: Drainage Water Management: a Tool that Interacts with the 4Rs
Harold Reetz, President, Reetz Agronomics LLC & Exec. Director, Agricultural Drainage Mgmt.Coalition
- Poster 6: A 4R Nutrient Stewardship Plan in Action
Bill Angstadt, Delaware and Maryland Agribusiness Association
- Poster 7: Accessing 4R Materials and Educational Tools
Kathy Mathers, Vice President of Public Affairs, The Fertilizer Institute

Poster Presentations

Sunday, July 17 – 6:30 p.m. – Ambassador and Regency Ballrooms

Time is allotted on Sunday afternoon between 1:30 and 4:00 p.m. to hang posters. Authors are asked to be at their poster during the Sunday evening reception in the Exhibit/Poster Hall.

Take down for posters in the Regency Ballroom is Monday at 3:30 p.m.

Take down for posters in the Ambassador Ballroom is Tuesday at 3:30 p.m.

Take down for CIG Posters in the Diplomat Ballroom is Tuesday at 5:00 p.m.

Special Symposia Session Posters will be in the Regency Ballroom. Time is allotted on Monday from 6:00 to 7:00 p.m. to hang the special symposia posters. Take down for these posters is Tuesday at 3:30 p.m.

Conservation Tools and Technologies - These posters are in Ambassador (Exhibit Hall)

1. Cover crop after maize to decrease the risk of nitrates leaching
Raul S. Lavado
2. Estimating Soil Organic Carbon Sequestration throughout the Cotton Belt with the Soil Conditioning Index
Alan J. Franzluebbers, USDA-ARS, Watkinsville GA
3. Evaluation of Planting Stock Size to Growth Performance for Conservation Plantings
Shawna Clark, USDA NRCS, Big Flats Plant Materials Center
4. Leveraging Geospatial Technologies for Ecological Monitoring of NRCS Conservation Easements
Gabriel Upchurch, University of Tennessee Institute of Agriculture
5. Native Seed Mixture Rate Calculation
Robert Glennon, USDA, NRCS (retired)
6. Vegetative Buffers for Poultry and Livestock Farms
Shawn Belt; U.S.D.A., N.R.C.S.- Norman A. Berg National Plant Materials Center
7. Using Rice Fields as a Mitigation Tool: A Mixture of Ecosystem Services, Conservation Technology, and Economics
Matthew T. Moore, USDA Agricultural Research Service

Adaptive Management of Conservation Efforts - These posters are in Regency (Plenary Room)

8. A GIS Assessment to Identify and Reduce Nitrate Loads that Contribute to Hypoxia in the Gulf of Mexico
Theodis Bunch, USDA/NRCS/NWMC
9. Correlation Between Vegetation Diversity and Environmental Factors in Natural Versus Restored Isolated Depressional Wetlands
Metthea Yepsen, University of Maryland
10. Managing and Assessing Climate Change Effects on Rangeland Ecosystem Goods and Services
Kristie Maczko, Sustainable Rangelands Roundtable - University of Wyoming
11. Native Plant Establishment in Late Summer
Joe Paternoster, DriWater Inc.

Soil and Water Conservation Society – 66th International Annual Conference

Conservation and Environmental Policy and Program Design - These posters are in Regency (Plenary Room)

12. Attitudes towards water conservation policies in the communities on the Ogallala
Lyubov A. Kurkalova, North Carolina A&T State University
13. Economic Modeling for Land Use Decision Making in Working Rural Landscapes
Andrew D. Carver, Southern Illinois University
14. Effective Strategies to Monitor, Manage, and Enforce Wetland Reserve Program Conservation Easements
Heath M. Hagy, University of Tennessee
15. Impact of nitrogen use efficiency on green house gas emission in canola biodiesel feedstock production
Ashley Hammac, Washington State University
16. Increasing the Cost-Effectiveness of Maryland's Cover Crop Program on the Eastern Shore
Jon Winsten, Winrock International
17. NRCS National Easement Assessment Project: Development of a National Monitoring Program to Assess Ecological Condition of Grassland Reserve Program Conservation Easements
Douglas C Osborne, University of Tennessee
18. Presentation Title Cooperative Approaches for Soil Erosion and Sediment Control in the Great Lakes Basin
Gary Overmier Great Lakes Commission
19. The Impact of Water Allocation Rules and Policies on Crop Production, Subsistence Requirements and Agricultural Revenues within Balkhab River Basin, Afghanistan
Andrew D. Carver, Department of Forestry, Southern Illinois University
20. USDA NRCS National Easement Assessment Project: Overview for Monitoring and Managing Conservation Easements
Katherine E. Edwards, University of Tennessee Institute of Agriculture, Department of Forestry, Wildlife and Fisheries, 274 Ellington Plant Sciences Building, Knoxville, TN, 37996

Conservation Outreach and Education - These posters are in Regency (Plenary Room)

21. An Economic Analysis of a Direct Seed Mentoring Project in the Washington-Idaho Palouse
Kathleen Painter, University of Idaho
22. Conewago Stream Teams - Innovative Pilot Approach to Youth Water Education
Jennifer Fetter, The Pennsylvania State University
23. Survey and Assessment of Agricultural Operations in the Conewago Creek Watershed
Michael G. Hubler, Dauphin County Conservation District

Soil Resource Management and Conservation - These posters are in Regency (Plenary Room)

24. Application of the Rangeland Hydrology and Erosion Model (RHEM) on Long-term Rangeland Monitoring Data in Southeastern Arizona
D. Phillip Guertin, School of Natural Resources and the Environment, University of Arizona
25. Assessment of salt tolerant perennial plants to remediate saline soils
Jeffrey A. Hemenway, NRCS, Huron SD
26. Blending soil conservation with production: Assessment of diverse crop rotations under no-till soil management for agronomic yield and soil C sequestration
Walter E. Riedell, USDA-ARS North Central Agricultural Research Laboratory, Brookings SD
27. Changes in soil phosphorus levels on a grazing farm in the Chesapeake Bay watershed
Matt A. Sanderson, USDA-ARS
28. Dormant Seeding of Switchgrass with and without Seed Treatments in New York
Paul Salon, USDA-NRCS
29. Effects from Trees, Quail Buffers, and Reduced Tillage on Runoff and Lake Water Quality in an Oxbow Lake Watershed
R. F. Cullum, USDA-ARS
30. Historical changes in sediment dynamics in Lake Toro catchment, Kushiro Mire, northern Japan over the last 300 years
Choong Hwa Lee, Korea Forest Research Institute, hwa21@forest.go.kr
31. Soil biogeochemical recovery after applying dolomite at a restored *Machilus thunbergii* stand
Choong Hwa, Korea Forest Research Institute, hwa21@forest.go.kr
32. Spending Our Soil Resources
Warren Busscher, USDA-ARS

Fish, Wildlife, and Biodiversity Conservation - These posters are in Regency (Plenary Room)

33. Planting Native Species to Control Site Reinfestation by Japanese Knotweed
Martin van der Grinten, USDA-Natural Resources Conservation Service
34. Warm-Season Grass Management Trials in Maryland
R. Jay Ugiansky, USDA, NRCS, National Plant Materials Center, Beltsville, MD.

Water Resources and Management - These posters are in Regency (Plenary Room)

35. Evaluating Phosphorus Losses from Tile-Drained Fields in Northern New York
Eric O. Young, William H. Miner Agricultural Research Institute
36. Extension Nutrient and Manure Management in the Upper Midwest: Measuring Regional Impact
Rebecca Power, University of Wisconsin-Extension
37. Initial Results of a Field Scale Bioreactor Demonstration Study
Keegan Kult, Iowa Soybean Association Environmental Programs and Services
38. Invasiveness of Woody and Herbaceous Plant Types into Established Prairie Grassland Communities
Steve Young, University of Nebraska-Lincoln
39. Long-term change of rainfall runoff response with afforestation in a coniferous forest catchment
Hyung Tae Choi, Korea Forest Research Institute
40. Pioneer Farm Surface and groundwater Monitoring Infrastructure
Justin K. Daugherty University of Wisconsin Platteville
41. Presentation Title Case Studies of Off-stream Storage for Water Conservation in Coastal Watersheds of Western North America
David Landsman, NOAA Restoration Center
42. The Open Source Science Project: Public involvement in a longitudinal nutrient survey of the Missouri-Mississippi River
Jeffrey Strock, University of Minnesota
43. Use of a Public-Private Partnership to Establish a Regionally Coordinated Water Monitoring Network to Aid in Watershed Decision Making
Anthony Seeman, Iowa Soybean Association Environmental Programs and Services
44. Water Quality in the Fort Cobb Watershed, Oklahoma: Spatial and Temporal Patterns of pH, Dissolved Oxygen, Redox Potential, Total Dissolved Solids, and Turbidity
Patrick J. Staks, USDA-ARS Grazinglands Research Laboratory
45. Water Quality in the Fort Cobb Watershed, USA: Spatial and Temporal Patterns of Nitrates in Streams
Daniel N. Moriasi, USDA ARS Grazinglands Research Laboratory, El Reno ,OK

THE Common Thread OF OUR TEAM



SOIL
AND WATER
CONSERVATION
SOCIETY

Shop Online at www.swcs.org

- Branded Wearables & Accessories
- Fashionable, High Quality
- Business to Casual Wear
- 24/7 Ordering
- Order 1 or More
- Name Brands
- Assorted Sizes, Including Youth
- Great Gift Ideas



Wear our Soil and Water Conservation Society logo with pride.

SHOP. WEAR. ENJOY.



SWCS Conference Sites and Presidents

- 1946 Chicago, IL, Ralph H. Musser
1947 Omaha, NE, Ralph H. Musser
1948 Cincinnati, OH, T.S. Buie
1949 St. Louis, MO, Lloyd E. Partain
1950 Detroit, MI, Firman E. Bear
1951 Memphis, TN, Morris E. Fonda
1952 Buffalo, NY, Morris E. Fonda
1953 Colorado Springs, CO, H.H. Bennett
1954 Jacksonville, FL, R.Y. Bailey
1955 Green Lake, WI, Austin L. Patrick
1956 Tulsa, OK, Edward H. Graham
1957 Pacific Grove, CA, J.S. Russell
1958 Asheville, NC, Russell G. Hill
1959 Rapid City, SD, Alvin C. Watson
1960 Guelph, ON, Elmer L. Sauer
1961 Lafayette, IN, Walter C. Gumbel
1962 Washington, DC, Roy D. Hockensmith
1963 Logan, UT, George M. Browning
1964 Jackson, MS, Herbert A. Hopper
1965 Philadelphia, PA, Minott Silliman, Jr.
1966 Albuquerque, NM, John R. J. Bradshaw
1967 Des Moines, IA, Cecil W. Chapman
1968 Athens, GA, Frank H. Mendell
1969 Fort Collins, CO, Ray Hunter
1970 Toronto, ON, Robert W. Eikleberry
1971 Columbus, OH, Einer L. Roget
1972 Portland, OR, J.R. Johnston
1973 Hot Springs, AR, A.B. Linford
1974 Syracuse, NY, William L. Vaught
1975 San Antonio, TX, Frank W. Schaller
1976 Minneapolis, MN, Chester E. Evans
1977 Richmond, VA, J. Vernon Martin
1978 Denver, CO, Arthur D. Latornell
1979 Ottawa, ON, William Moldenhauer
1980 Dearborn, MI, Gerald R. Calhoun
1981 Spokane, WA, Jesse L. Hicks
1982 New Orleans, LA, Robert C. Baum
1983 Hartford, CT, Chris J. Johannsen
1984 Oklahoma City, OK, Floyd E. Heft
1985 St. Louis, MO, Roland R. Willis
1986 Winston-Salem, NC, Joe D. Nichols
1987 Billings, MT, Maurice G. Cook
1988 Columbus, OH, Donald Van Meter
1989 Edmonton, AB, David R. Cressman
1990 Salt Lake City, UT, Richard Duesterhaus
1991 Lexington, KY, Richard Duesterhaus
1992 Baltimore, MD, Ronald J. Hicks
1993 Fort Worth, TX, Ronald J. Hicks
1994 Norfolk, VA, Calvin J. Perkins
1995 Des Moines, IA, Gary Steinhardt
1996 Keystone Resort, CO, John A. Knapp
1997 Toronto, ON, Aniko Szojka-Parnell
1998 San Diego, CA, Aniko Szojka-Parnell
1999 Biloxi, MS, Dennis Pate
2000 St. Louis, MO, Dennis Pate
2001 Myrtle Beach, SC, Dana Chapman
2002 Indianapolis, IN, Bob Eddleman
2003 Spokane, WA, Myron Senechal
2004 St. Paul, MN, Deborah Cavanaugh-Grant
2005 Rochester, NY, Jean Steiner
2006 Keystone Resort, CO, Jean Steiner
2007 Tampa, FL, Theo Dillaha
2008 Tucson, AZ, Peggie James
2009 Dearborn, MI, Peggie James
2010 St. Louis, MO, Gary Steinhardt
2011 Washington, DC, Bill Boyer
2012 Fort Worth, TX, Bill Boyer
2013 Reno, NV
2014 Chicago, IL